



City of Rio Communities Council Regular Business Meeting

City Council Chambers - 360 Rio Communities Blvd

Rio Communities, NM 87002

Monday, June 22, 2026 6:00 PM

Agenda

Please silence all electronic devices.

Mayor - Joshua Ramsell

Mayor Pro Tem - Lawrence R. Gordon

Council – Michael Melendez, Thomas Nelson, Matthew Marquez

Call to Order

Pledge of Allegiance

Roll Call

Approval of Agenda

Consent Agenda

1. **Approval of Minutes Regular Business Meeting June 8, 2026**
2. **Approval of Accounts Payable**

Public Comment: The Municipal Clerks office will accept public comments via email until noon on June 22, 2026 If you wish to speak during the public comment session, the Council will allow each member of the public to three (3) minutes to address the Council. Both the public and Council will follow rules of decorum. Give your name and where you live. The public will direct comments to the City Council. Comment(s) will not be disruptive or derogatory. The Council will not take action or engage in discussion regarding the comments made or received, but when appropriate the matters raised may be referred to staff or others for further review. Both the public and Council will follow rules of decorum. Derogatory Comments or matters under litigation will not be allowed and any person or persons addressing the Council are liable for their own statements.

Manager Report

3. **Maverick Update**
4. **Don Diego Update**
5. **Earthquakes South of Rio Communities.**

Action Items

6. **Discussion, Consideration, and Decision – Approval of Fireworks Ban Proclamation.**
7. **Discussion, Consideration, and Decision – Authorization to expend up to One Hundred and Thirty Thousand Dollars (\$130,000.00) of Bill Brown Fund for Veterans’ Memorial Park Effective July 1, 2026.**

Executive Session - For the purpose of a matter subject to attorney-client privilege, for the limited purpose of discussing threatened or pending litigation (Felix Nunez v. City of Rio Communities, et. al.) pursuant to §10-15-1(H)(8).* Motion and roll call vote to go into close session

*** Motion and roll call vote to go back into the regular business meeting session**

*** Welcome everyone back and statement by the Mayor:**

Council Discussion

Adjourn

Please join us from the comfort and safety of your own home by entering the following link: @
<http://www.youtube.com/@CityofRioCommunities>



City of Rio Communities Council Regular Business Meeting
City Council Chambers - 360 Rio Communities Blvd
Rio Communities, NM 87002
Monday June 8, 2026, 6:00 PM
Minutes

Please silence all electronic devices.

Mayor - Joshua Ramsell

Mayor Pro Tem - Lawrence R. Gordon

Council – Michael Melendez, Thomas Nelson, Matthew Marquez

Call to Order

Mayor Ramsell called the meeting to order at 6:01pm

Pledge of Allegiance

Councilor Melendez led the pledge of allegiance.

Roll Call

Governing Body

Mayor Joshua Ramsell

Councilor Matthew Marquez

Councilor Lawrence Gordon (Via Phone)

Councilor Thomas Nelson

Councilor Michael Melendez

Staff

Manager Dr. Martin Moore

City Attorney Cori Strife

Approval of Agenda

Motion made by Councilor Melendez to approve agenda. Seconded by Councilor Nelson.

Voting Yea:

Councilor Marquez

Councilor Nelson

Councilor Melendez

Councilor Gordon

Motion Passed with a 4-0 Vote

Consent Agenda

Motion made by Councilor Nelson to approve consent agenda. Seconded by Councilor Melendez.

Voting Yea:

Councilor Melendez

Councilor Marquez

Councilor Nelson

Councilor Gordon

Motion passed with a 4-0 vote

Manager Report

Maverick Update.

Don Diego Update

City Complex Update.

Action Items

Discussion, Consideration, and Decision – Resolution 2026-10 Budget Adjustment for Fiscal Year 2026

Motion made by Councilor Nelson to approve Discussion, Consideration, and Decision – Resolution 2026-10 Budget Adjustment for Fiscal Year 2026. Seconded by Councilor Marquez.

Voting Yea:

Councilor Melendez

Councilor Marquez

Councilor Nelson

Councilor Gordon

Motion passed with a 4-0 vote

Executive Session -For the purpose of the discussion of the purchase, addition or disposal of real property or water rights by the public body pursuant to NMSA 10-15-1(H)(8); and pursuant to §10-15-1(H)(7) For the purpose of a matter subject to attorney-client privilege, for the limited purpose of discussing threatened or pending litigation

Motion and roll call vote to go into close session

Motion made by Councilor Nelson to go into close session. Seconded by Councilor Gordon.

Voting Yea:

Councilor Melendez

Councilor Marquez

Councilor Nelson

Councilor Gordon

Motion passed with a 4-0 vote at 6:25pm

Motion and roll call vote to go back into the regular business meeting session

Motion made by Councilor Nelson to go back into the regular business meeting session. Seconded by Councilor Melendez.

Voting Yea:

Councilor Melendez
Councilor Marquez
Councilor Nelson
Councilor Gordon

Motion passed with a 4-0 vote at 7:11pm

Welcome everyone back and statement by the Mayor:

Mayor Ramsell Stated that on Monday June 8, 2026, City of Rio Communities City Council did hold an Executive Session - For the purpose of the discussion of the purchase, addition or disposal of real property or water rights by the public body pursuant to NMSA 10-15-1(H)(8); and pursuant to §10-15-1(H)(7) For the purpose of a matter subject to attorney-client privilege, for the limited purpose of discussing threatened or pending litigation. No Action was taken and no other items were discussed at this time.

Motion made by Councilor Nelson to approve the statement by the mayor. Seconded by Councilor Gordon.

Voting Yea:
Councilor Melendez
Councilor Marquez
Councilor Nelson
Councilor Gordon

Motion passed with a 4-0 vote.

Action Item

Discussion, Consideration, and Decision – Approve or Disapprove the Purchase of UPC 1010026436166000000 S: 27 T: 5N R: 2E A PARCEL OF LAND SITUATED WITHIN THE EXTERIOR BOUNDARIES OF THE TOME GRANT IN VALENCIA COUNTY NEW MEXICO 660' X 660' 10.00 ACRES

Motion made by Councilor Melendez to approve the Purchase of UPC 1010026436166000000 S: 27 T: 5N R: 2E A PARCEL OF LAND SITUATED WITHIN THE EXTERIOR BOUNDARIES OF THE TOME GRANT IN VALENCIA COUNTY NEW MEXICO 660' X 660' 10.00 ACRES. Seconded by Councilor Gordon.

Voting Yea:
Councilor Melendez
Councilor Marquez
Councilor Nelson
Councilor Gordon

Motion passed with a 4-0 vote.

Council Discussion

Our Next Regular Scheduled Meeting will be Tuesday, June 22, 2026, at 6:00pm

Adjourn at 7:45pm

Respectfully submitted,

Jennifer Gauna Municipal clerk
(Taken and Transcribed by Patricia McCloskey, Deputy Clerk)

Date: _____

Approved:

Joshua Ramsell,
Mayor

Lawrence R. Gordon,
Mayor Pro-tem/Councilor

Michael Melendez,
Councilor

Thomas Nelson,
Councilor

Matthew Marquez,
Councilor



Expense Approval Register

Packet: APPKT01938 - AP 6.16.26

Vendor Name	Payable Number	Post Date	Description (Item)	Account Number	Amount
Fund: 11000 - General Operating Fund					
Sharp Electronics Corporatio	INV#42209590	06/15/2026	Police Department Copies	11000-3001-57090	23.41
Comcast Business	INV# 271402316	06/16/2026	City Hall Telecommunication	11000-2002-57160	533.23
Comcast Business	INV# 271402316	06/16/2026	Code/Fire/EMS Telecommun	11000-3002-57160	1,127.74
Amazon Business	INV#1JMN-H37L-1QM3 AND	06/16/2026	Velcro/No Smoking Sign/Lab	11000-3001-56020	51.26
Amazon Business	INV#1JMN-H37L-1QM3 AND	06/16/2026	Velcro/No Smoking Sign/Lab	11000-3001-56040	47.87
Albuquerque Publishing Co.	INV#408690	06/16/2026	Budget Public Hearing Notic	11000-2004-57090	71.00
Sharp Electronics Corporatio	INV#42209589	06/16/2026	Finance Department Copies	11000-2004-57090	25.99
NM Local Government Law	INV#4328	06/16/2026	Legal Services -FY 2024-2025	11000-2002-55020	5,991.48
Prudential Overall Supply	INV#450796500	06/16/2026	Uniform Rental - Open PO	11000-5101-56999	50.00
Prudential Overall Supply	INV#450797166 \$50.00	06/16/2026	Uniform Rental - Open PO	11000-5101-56999	50.00
DBC Waters LLC	INVOICE#324572	06/16/2026	Bottled Water Delivery SVS	11000-2002-56060	15.55
Albuquerque Publishing Co.	INV#352280	06/08/2026	Police Chief Job Posting	11000-1001-57090	1,093.27
Fund 11000 - General Operating Fund Total:					9,080.80
Fund: 20600 - Emergency Medical Services					
McKesson Medical-Surgical	INV#25027298	06/16/2026	medical supplies	20600-3003-56030	108.70
McKesson Medical-Surgical	INV#25507242	06/16/2026	medical supplies	20600-3003-56030	258.36
McKesson Medical-Surgical	INV#25507390	06/16/2026	medical supplies	20600-3003-56030	50.09
McKesson Medical-Surgical	INV#25750335	06/16/2026	med supplies	20600-3003-56070	1,111.44
Fund 20600 - Emergency Medical Services Total:					1,528.59
Fund: 20900 - Fire Protection					
Waterway of NM, LLC.	INV#4283	06/16/2026	annual hose testing	20900-3002-55999	3,386.00
Waterway of NM, LLC.	INV#4284	06/16/2026	Annual pump test	20900-3002-55999	1,436.49
Prudential Overall Supply	INV#450797165	06/16/2026	uniforms	20900-3002-56110	92.99
Napa Auto Parts	INV#583011	06/16/2026	open p.o. vehicle mainten	20900-3002-54040	189.99
Sharp Electronics Corporatio	INV#9005830291	06/16/2026	Fire Department Copies	20900-3002-57090	65.31
Prudential Overall Supply	INV#450796499	06/08/2026	uniforms	20900-3002-56110	97.73
Fund 20900 - Fire Protection Total:					5,268.51
Fund: 21100 - Law Enforcement Protection					
Melloy Ford	INV# FOCS115129	06/16/2026	UNIT 02- LABOR/DIAGNOSIS	21100-3001-54040	612.95
Fund 21100 - Law Enforcement Protection Total:					612.95
Fund: 30300 - State Legislative Appropriation Project					
Garcia & Sons Security	1461 -1462	06/16/2026	Police Department Lock and	30300-2002-54010	382.00
Garcia & Sons Security	1461 -1462	06/16/2026	Library door lock and keys	30300-2002-54010	74.02
Fund 30300 - State Legislative Appropriation Project Total:					456.02
Fund: 30400 - Road/Street Projects					
HDR Engineering, Inc.	INV#1200832075	06/16/2026	Construction Observation SV	30400-2002-55030	21,199.00
HDR Engineering, Inc.	INV#1200832075	06/16/2026	Project Management	30400-2002-55030	121.00
HDR Engineering, Inc.	INV#1200832075	06/16/2026	NM GRT	30400-2002-55030	1,769.56
Fund 30400 - Road/Street Projects Total:					23,089.56
Fund: 39900 - Other Capital Projects					
HDR Engineering, Inc.	INV#1200832054	06/16/2026	On-Call Engineering	39900-2002-55030	698.26
Fund 39900 - Other Capital Projects Total:					698.26
Grand Total:					40,734.69

Fund Summary

Fund	Expense Amount
11000 - General Operating Fund	9,080.80
20600 - Emergency Medical Services	1,528.59
20900 - Fire Protection	5,268.51
21100 - Law Enforcement Protection	612.95
30300 - State Legislative Appropriation Project	456.02
30400 - Road/Street Projects	23,089.56
39900 - Other Capital Projects	698.26
Grand Total:	40,734.69

Account Summary

Account Number	Account Name	Expense Amount
11000-1001-57090	Printing/Publishing/Adv	1,093.27
11000-2002-55020	Contract - Attorney Fees	5,991.48
11000-2002-56060	Supplies - Kitchen	15.55
11000-2002-57160	Telecommunications	533.23
11000-2004-57090	Printing/Publishing/Adv	96.99
11000-3001-56020	Supplies - General Office	51.26
11000-3001-56040	Supplies-Furniture/Fixtu	47.87
11000-3001-57090	Printing/Publishing/Adv	23.41
11000-3002-57160	Telecommunications	1,127.74
11000-5101-56999	Supplies - Other	100.00
20600-3003-56030	Supplies - Field Supplies	417.15
20600-3003-56070	Supplies - Medical	1,111.44
20900-3002-54040	Maintenance & Repairs -	189.99
20900-3002-55999	Contract - Other Service	4,822.49
20900-3002-56110	Supplies - Uniforms/Line	190.72
20900-3002-57090	Printing/Publishing/Adv	65.31
21100-3001-54040	Maintenance & Repairs -	612.95
30300-2002-54010	Maintenance & Repairs -	456.02
30400-2002-55030	Contract - Professional S	23,089.56
39900-2002-55030	Contract - Professional S	698.26
Grand Total:	40,734.69	

Project Account Summary

Project Account Key	Expense Amount
None	40,734.69
Grand Total:	40,734.69

Authorization Signatures

MAYOR & COUNCILORS

JOSHUA RAMSELL, MAYOR

LAWRENCE GORDON, COUNCILOR

MICHAEL MELENDEZ, COUNCILOR

MATTHEW MARQUEZ, COUNCILOR

THOMAS NELSON, COUNCILOR

ATTEST:

MUNICIPAL CLERK



CITY OF RIO COMMUNITIES

FROM THE OFFICE OF THE MAYOR

PROCLAMATION Regarding Fireworks Ban and Restricted Use During Severe Drought

- WHEREAS,** the City of Rio Communities is committed to protecting the health, safety, and welfare of its residents, businesses, public infrastructure, and natural resources; and
- WHEREAS,** current drought conditions continue to affect much of the State of New Mexico, including Valencia County, resulting in dry vegetation, low soil moisture, and elevated wildfire potential; and
- WHEREAS,** the United States Drought Monitor and National Weather Service indicate that significant portions of New Mexico remain under Moderate, Severe, and Extreme Drought classifications; and
- WHEREAS,** seasonal weather forecasts continue to predict above-normal temperatures, below-normal precipitation, and continued drought conditions throughout central New Mexico during the summer fire season; and
- WHEREAS,** prolonged drought conditions combined with low humidity, high temperatures, accumulated vegetation fuels, and frequent wind events substantially increase the risk of wildland, brush, grass, and structure fires within and surrounding the City of Rio Communities; and
- WHEREAS,** the occurrence of such fires poses a significant threat to life, property, public infrastructure, and emergency response resources; and
- WHEREAS,** Pursuant to the New Mexico Fireworks Licensing and Safety Act, Section 60-2C-1 et. seq. NMSA 1978, as amended, the City of Rio Communities is authorized to ban or restrict the use and sale of certain fireworks when extreme or severe drought conditions exist as determined by the NWS indices and other relevant information supplied by the United States Forest Service; and

WHEREAS, New Mexico Statutes Annotated (NMSA) 60-2C-8.1B (1999) states that the governing body of a municipality, based on current drought indices published by the national weather service, shall “issue a proclamation declaring extreme or severe fire conditions within the boundaries of the incorporated municipality”; and the proclamation (NMSA 2C-60-8.1B1) “shall ban the sale and use of missile-type rockets, helicopters, aerial spinners, stick-type rockets, and ground audible devices within the affected drought area”; and

WHEREAS. (NMSA 60-2C-8.1B2) “shall give the governing body the power to (NMSA 60-2C-8.1B2a) “limit the use within its jurisdiction of any fireworks not listed in (NMSA 2C-60-8.1B1) to areas that are paved or barren or that have a readily accessible source of water for use” and (NMSA 60-2C-8.1B2c) to ban or restrict the sale or use of display fireworks”; and

WHEREAS, (NMSA 60-8.1C) The proclamation “shall be issued no less than 20 days prior to a holiday for which fireworks may be sold”;

NOW THEREFORE, BE IT HEREBY ORDAINED that the City of Rio Communities declares an exceptional drought condition exists in our municipality and high fire risk hazards represent a significant and immediate threat to the safety, health, and welfare to the residents of Rio Communities; and,

THEREFORE, in accordance with State Statute, the sale and use of specified permissible aerial and ground audible fireworks are banned within the city limits for 30 days from the date of proclamation enactment. Banned fireworks are aerial spinners; helicopters; mines; missile-type rockets; roman candles; shells; stick-type rockets and ground audible chasers and firecrackers; and,

THEREFORE, in accordance with State Statute and City Ordinance 2021 – 79 Chapter 11 Article 1 Fireworks Control, the use of permissible specified fireworks is restricted within the city limits for 30 days from the date of proclamation enactment. Restricted fireworks are cone fountains, crackling devices, cone fountains, crackling devices, cylindrical fountains, flitter sparklers, ground spinners, illuminating torches, toy smoke devices, and wheels, which may only be used in areas that are paved, barren or have an accessible source of water for use by the homeowner or the general public; and,

THEREFORE, any City approved display of fireworks requires a written permit from the City, and the display fireworks shall be purchased from a distributor or display distributor licensed by the State Fire Marshal and the Bureau of Alcohol, Tobacco and Firearms at the United States Department of Treasury, pursuant to NMSA 60-2C-9,1978.

DULY PROCLAIMED this 22nd day of June 2026.

Joshua Ramsell,
Mayor

Attest: _____
Jennifer Gauna – Municipal Clerk



MWGS-Rio Community Veterans

Preliminary Construction Estimate-Not to Exceed

Item	Quantity	UNIT	Unit Cost	Total
Mobilization	1	LS	\$ 4,000.00	\$4,000.00
Temp Fence	1	LS	\$ 2,500.00	\$2,500.00
Surveying	1	LS	\$ 6,000.00	\$6,000.00
Materials Testing	1	LS	\$ 4,000.00	\$4,000.00
Demolition (remove 26 shrubs and 2 trees)	1	LS	\$ 4,200.00	\$4,200.00
Dig up and relocate tree (4" cal)	2	EA	\$ 1,500.00	\$3,000.00
Irrigation Modifications	1	EA	\$ 7,500.00	\$7,500.00
Grading/Earth Work	1	LS	\$ 5,400.00	\$5,400.00
Brick Pavers	62	SF	\$ 60.00	\$3,720.00
Concrete paving	787	SF	\$ 18.00	\$14,166.00
Paver Restraint	4	LF	\$ 20.00	\$80.00
Vertical Stone	1	EA	\$ 6,500.00	\$6,500.00
4'-0" Ht Concrete Retaining Wall	38	LF	\$ 700.00	\$26,600.00
Memorial Plaque	1	EA	\$ 2,800.00	\$2,800.00
Flagpole (Install owner provided flagpole)	3	EA	\$ 3,000.00	\$9,000.00
Salvaged Gravel	1,725	SF	\$ 5.00	\$8,625.00
Boulders (Install only-Owner to Provide)	6	EA	\$ 300.00	\$1,800.00
Subtotal				\$109,891.00
Sales tax (8.30%)				\$9,120.95
Total including tax				\$119,011.95

Detailed Scope of Work

Date: 6/11/2026
Work Order #: 156523.00
Title: Rio Communities - Veteran's Memorial
Contractor: Mountain West Golfscapes Inc
Contractor Number: PRO-JOCA-5878-2026
Job Order Value: \$118,527.65

Location: Rio Communities

Detailed Scope:

Construction of Veteran's Memorial Wall to include:
Selective removal of existing landscape
Re-location of two existing trees
New concrete flatwork and wall
Installation of Memorial Stone and Plaque
Installation of three new flagpoles
Restoration of landscape gravel

Contractor Price Proposal Details - CSI

Date: 6/11/2026
Work Order #: 156523.00
Title: Rio Communities - Veteran's Memorial
Contractor: Mountain West Golfscapes Inc
Contractor Number: PRO-JOCA-5878-2026
Job Order Value: \$118,527.65

Proposal Name: Rio Communities - Veteran's Memorial
Proposal Value: \$118,527.65

CSI Number	Mod	UOM	Description	LineTotal
01 - General Requirements				
1	01 22 16 00-0004	EA	New Mexico Gross Receipts Tax – Varies by County	\$9,083.84
			Qty Unit Price Factor Total	
			Installation 9,083.84 X \$1.00 X 1.0000 \$9,083.84	
			0	
			<i>Contractor Notes: Tax Rate @ 8.3000%</i>	
2	01 22 20 00-0015	HR	LaborerFor tasks not included in the Construction Task Catalog® and as directed by owner only.	\$4,697.60
			Qty Unit Price Factor Total	
			Installation 80.000 X \$36.70 X 1.6000 \$4,697.60	
			<i>Contractor Notes: Set owner provided memorial stone</i>	
3	01 22 20 00-0015	HR	LaborerFor tasks not included in the Construction Task Catalog® and as directed by owner only.	\$3,523.20
			Qty Unit Price Factor Total	
			Installation 60.000 X \$36.70 X 1.6000 \$3,523.20	
			<i>Contractor Notes: Install solar panels on owner provided flagpoles</i>	
4	01 22 20 00-0015	HR	LaborerFor tasks not included in the Construction Task Catalog® and as directed by owner only.	\$1,761.60
			Qty Unit Price Factor Total	
			Installation 30.000 X \$36.70 X 1.6000 \$1,761.60	
			<i>Contractor Notes: Install owner provided memorial plaque</i>	
5	01 22 20 00-0015	HR	LaborerFor tasks not included in the Construction Task Catalog® and as directed by owner only.	\$5,872.00
			Qty Unit Price Factor Total	
			Installation 100.000 X \$36.70 X 1.6000 \$5,872.00	
			<i>Contractor Notes: Irrigation modifications</i>	
6	01 22 20 00-0015	HR	LaborerFor tasks not included in the Construction Task Catalog® and as directed by owner only.	\$5,872.00
			Qty Unit Price Factor Total	
			Installation 100.000 X \$36.70 X 1.6000 \$5,872.00	
			<i>Contractor Notes: Stockpile existing gravel for re-use</i>	

CSI Number	Mod	UOM	Description	LineTotal
01 - General Requirements				
7	01 22 20 00-0015	HR	LaborerFor tasks not included in the Construction Task Catalog® and as directed by owner only.	\$3,523.20
			Qty Unit Price Factor Total	
		Installation	60.000 X \$36.70 X 1.6000	\$3,523.20
		Contractor Notes: Set owner provided boulders		
8	01 22 20 00-0046	HR	Surveyor, Instrument PersonFor tasks not included in the Construction Task Catalog® and as directed by owner only.	\$3,958.08
			Qty Unit Price Factor Total	
		Installation	60.000 X \$41.23 X 1.6000	\$3,958.08
9	01 22 20 00-0047	HR	Surveyor, Rod PersonFor tasks not included in the Construction Task Catalog® and as directed by owner only.	\$3,929.28
			Qty Unit Price Factor Total	
		Installation	60.000 X \$40.93 X 1.6000	\$3,929.28
10	01 22 23 00-1038	DAY	10,000 Lb. Capacity, Telescopic Boom, Hi-Reach, Rough Terrain Construction Forklift With Full-Time Operator	\$1,979.58
			Qty Unit Price Factor Total	
		Installation	1.000 X \$1,237.24 X 1.6000	\$1,979.58
		Contractor Notes: Setting owner provided memorial stone		
11	01 71 13 00-0003	EA	Equipment Delivery, Pickup, Mobilization And Demobilization Using A Tractor Trailer With Up To 53' BedIncludes loading, tie-down of equipment, delivery of equipment, off loading on site, rigging, dismantling, loading for return and transporting away. For equipment such as bulldozers, motor scrapers, hydraulic excavators, gradalls, road graders, loader-backhoes, heavy-duty construction loaders, tractors, pavers, rollers, bridge finishers, straight mast construction forklifts, telescoping boom rough terrain construction forklifts, telescoping and articulating boom man lifts with >40' boom lengths, etc.	\$3,672.90
			Qty Unit Price Factor Total	
		Installation	2.000 X \$1,147.78 X 1.6000	\$3,672.90
12	01 74 13 00-0003	CY	Collect Existing Debris And Load Into Truck Or DumpsterPer CY of debris removed.	\$890.40
			Qty Unit Price Factor Total	
		Installation	50.000 X \$11.13 X 1.6000	\$890.40
13	01 74 19 00-0016	EA	30 CY Dumpster (4 Ton) "Construction Debris"Includes delivery of dumpster, rental cost, pick-up cost, hauling, and disposal fee. Non-hazardous material.	\$2,037.09
			Qty Unit Price Factor Total	
		Installation	2.000 X \$636.59 X 1.6000	\$2,037.09
Subtotal for 01 - General Requirements:				\$50,800.77
02 - Existing Conditions				
14	02 41 13 13-0040	SF	>3" To 6" By Hand, Break-up And Remove Bituminous Paving	\$79.68
			Qty Unit Price Factor Total	
		Installation	20.000 X \$2.49 X 1.6000	\$79.68

CSI Number	Mod	UOM	Description	LineTotal
02 - Existing Conditions				
15	02 41 19 13-0060	EA	Minimum Charge For Saw CutFor projects where the total saw cutting charge is less than the minimum charge, use this task exclusively. This task should not be used in conjunction with any other tasks in this section.	\$1,201.04
			Qty Unit Price Factor Total	
		Installation	1.000 X \$750.65 X 1.6000	\$1,201.04
Subtotal for 02 - Existing Conditions:				\$1,280.72
03 - Concrete				
16	03 05 13 00-0024	CY	Ultra Premium Color (See Davis Colors Color Card), Concrete Admixture	\$2,813.60
			Qty Unit Price Factor Total	
		Installation	10.000 X \$175.85 X 1.6000	\$2,813.60
17	03 11 13 00-0005	SF	Mat Foundation Wood Formwork	\$990.40
			Qty Unit Price Factor Total	
		Installation	100.000 X \$6.19 X 1.6000	\$990.40
18	03 11 13 00-0005	0001 MOD	For <1,000, Add	\$180.80
			Qty Unit Price Factor Total	
		Installation	100.000 X \$1.13 X 1.6000	\$180.80
19	03 11 13 00-0005	0002 MOD	For Foundations >8' Below Grade, Add	\$171.20
			Qty Unit Price Factor Total	
		Installation	100.000 X \$1.07 X 1.6000	\$171.20
20	03 11 13 00-0005	0003 MOD	For Curved Formwork, Add	\$344.00
			Qty Unit Price Factor Total	
		Installation	100.000 X \$2.15 X 1.6000	\$344.00
21	03 11 13 00-0009	LF	Up To 6" High Slab Edge and Block-Out Wood Formwork	\$668.16
			Qty Unit Price Factor Total	
		Installation	120.000 X \$3.48 X 1.6000	\$668.16
22	03 11 13 00-0009	0003 MOD	For Curved Formwork, Add	\$232.32
			Qty Unit Price Factor Total	
		Installation	120.000 X \$1.21 X 1.6000	\$232.32
23	03 11 13 00-0009	0004 MOD	For Up To 250, Add	\$120.96
			Qty Unit Price Factor Total	
		Installation	120.000 X \$0.63 X 1.6000	\$120.96
24	03 11 13 00-0020	SF	Up To 8' High Above Grade Wall Wood Formwork	\$5,318.40
			Qty Unit Price Factor Total	
		Installation	400.000 X \$8.31 X 1.6000	\$5,318.40
25	03 11 13 00-0020	0006 MOD	For Curved Formwork, Add	\$1,817.60
			Qty Unit Price Factor Total	
		Installation	400.000 X \$2.84 X 1.6000	\$1,817.60

CSI Number	Mod	UOM	Description	LineTotal
03 - Concrete				
26	03 11 13 00-0020	0008	MOD For <1,000, Add	\$960.00
			Qty Unit Price Factor Total	
			Installation 400.000 X \$1.50 X 1.6000 \$960.00	
27	03 11 13 00-0090		LF 3/4" Wide Chamfer Strips for Concrete Formwork, All Materials	\$246.40
			Qty Unit Price Factor Total	
			Installation 100.000 X \$1.54 X 1.6000 \$246.40	
28	03 11 16 13-0002		SF Various Patterns And Textures, 1 Use, Concrete Form Liner, Add To Formwork	\$1,504.00
			Qty Unit Price Factor Total	
			Installation 250.000 X \$3.76 X 1.6000 \$1,504.00	
29	03 21 11 00-0003		LF #4, Grade 40, Beams And Girders, Steel Reinforcement Bar	\$3,424.00
			Qty Unit Price Factor Total	
			Installation 2,000.00 X \$1.07 X 1.6000 \$3,424.00	
30	03 31 13 00-0023		CY Concrete Pump, Place 3,000 PSI Concrete Spread FootingsExcludes pumping equipment.	\$2,016.48
			Qty Unit Price Factor Total	
			Installation 5.000 X \$252.06 X 1.6000 \$2,016.48	
31	03 31 13 00-0023	0038	MOD For Up To 20, Add	\$121.60
			Qty Unit Price Factor Total	
			Installation 5.000 X \$15.20 X 1.6000 \$121.60	
32	03 31 13 00-0037		CY Up To 6", By Concrete Pump, Place 3,000 PSI Concrete Slab On GradeExcludes pumping equipment.	\$4,051.34
			Qty Unit Price Factor Total	
			Installation 11.000 X \$230.19 X 1.6000 \$4,051.34	
33	03 31 13 00-0037	0038	MOD For Up To 20, Add	\$113.70
			Qty Unit Price Factor Total	
			Installation 11.000 X \$6.46 X 1.6000 \$113.70	
34	03 31 13 00-0069		CY 12" Thick, By Concrete Pump, Place 3,000 PSI Concrete WallsExcludes pumping equipment.	\$4,008.64
			Qty Unit Price Factor Total	
			Installation 10.000 X \$250.54 X 1.6000 \$4,008.64	
35	03 31 13 00-0069	0043	MOD For Up To 20, Add	\$233.60
			Qty Unit Price Factor Total	
			Installation 10.000 X \$14.60 X 1.6000 \$233.60	
36	03 31 13 00-0087		CY Delivery Fee For Small Concrete Purchases (Short Load) Per CY For Each CY Less Than 9 CYThe task quantity is 9 minus the number of CY's delivered. For example, the delivery fee for 2CY's is: (9-2) = 7.	\$1,080.00
			Qty Unit Price Factor Total	
			Installation 25.000 X \$27.00 X 1.6000 \$1,080.00	

CSI Number	Mod	UOM	Description	LineTotal
03 - Concrete				
37		SF	Broom, Concrete Floor Finish	\$12.50
			Qty Unit Price Factor Total	
			Installation 11.000 X \$0.71 X 1.6000 \$12.50	
38	0048	MOD	For Up To 100, Add	\$24.99
			Qty Unit Price Factor Total	
			Installation 11.000 X \$1.42 X 1.6000 \$24.99	
39		HR	35 CY/HR, 66 HP Trailer Mounted Concrete PumpIncludes hoses	\$4,785.41
			Qty Unit Price Factor Total	
			Installation 24.000 X \$124.62 X 1.6000 \$4,785.41	
Subtotal for 03 - Concrete:				\$35,240.10
10 - Specialties				
40		EA	25' Exposed Height, Tapered White Fiberglass Flagpole6" butt diameter, 3" top diameter and 0.180" wall.	\$4,504.85
			Qty Unit Price Factor Total	
			Installation 3.000 X \$938.51 X 1.6000 \$4,504.85	
41		EA	20' To 25' Flagpole, Direct Embedded Pole Base	\$3,207.89
			Qty Unit Price Factor Total	
			Installation 3.000 X \$668.31 X 1.6000 \$3,207.89	
Subtotal for 10 - Specialties:				\$7,712.74
31 - Earthwork				
42		CY	Hand Loading Of Cleared And Grubbed Material	\$817.44
			Qty Unit Price Factor Total	
			Installation 30.000 X \$17.03 X 1.6000 \$817.44	
43		EA	>6" To 12" D.B.H. (Diameter At Breast Height) Tree RemovalIncludes cutting up tree, chipping and loading.	\$1,676.26
			Qty Unit Price Factor Total	
			Installation 2.000 X \$523.83 X 1.6000 \$1,676.26	
44		EA	>6" To 12" Diameter Stump RemovalIncludes excavation necessary to remove stump and loading.	\$438.85
			Qty Unit Price Factor Total	
			Installation 2.000 X \$137.14 X 1.6000 \$438.85	
45		EA	Removal Of 36" To 42" Shrub, Evergreen	\$2,613.31
			Qty Unit Price Factor Total	
			Installation 26.000 X \$62.82 X 1.6000 \$2,613.31	
46		SF	Trim And Shape Machine Excavated Area By Hand Finish Grade	\$7,520.00
			Qty Unit Price Factor Total	
			Installation 10,000.00 X \$0.47 X 1.6000 \$7,520.00	

CSI Number	Mod	UOM	Description	LineTotal
31 - Earthwork				
47	31 22 19 13-0006	SF	Fine Grade Gravel By Hand Finish Grade	\$5,920.00
			Qty Unit Price Factor Total	
			Installation 10,000.0 X \$0.37 X 1.6000 \$5,920.00	
48	31 23 16 13-0003	CY	Over 12" Wide, Excavation for Trenching by Machine in Soil	\$393.60
			Qty Unit Price Factor Total	
			Installation 50.000 X \$4.92 X 1.6000 \$393.60	
49	31 23 16 13-0003	0060 MOD	For >20 To 50, Add	\$295.20
			Qty Unit Price Factor Total	
			Installation 50.000 X \$3.69 X 1.6000 \$295.20	
50	31 23 16 13-0012	CY	Backfilling or Placing Subbase for Trenches with Imported or Stockpiled Materials by Machine	\$183.20
			Qty Unit Price Factor Total	
			Installation 50.000 X \$2.29 X 1.6000 \$183.20	
51	31 23 16 13-0012	0065 MOD	For >20 To 50, Add	\$137.60
			Qty Unit Price Factor Total	
			Installation 50.000 X \$1.72 X 1.6000 \$137.60	
52	31 23 16 13-0015	CY	Compaction of Fill or Subbase for Trenches by Vibratory Plate, Air Tamper, etc.	\$266.40
			Qty Unit Price Factor Total	
			Installation 50.000 X \$3.33 X 1.6000 \$266.40	
53	31 23 16 13-0015	0070 MOD	For >20 To 50, Add	\$200.00
			Qty Unit Price Factor Total	
			Installation 50.000 X \$2.50 X 1.6000 \$200.00	
54	31 23 16 33-0020	CY	Loading Excess Material For Removal From Bulk Excavation	\$319.20
			Qty Unit Price Factor Total	
			Installation 50.000 X \$3.99 X 1.6000 \$319.20	
Subtotal for 31 - Earthwork:				\$20,781.06
32 - Exterior Improvements				
55	32 14 09 00-0006	LF	>2" To 3" Height, Aluminum Paver Restraint	\$118.08
			Qty Unit Price Factor Total	
			Installation 10.000 X \$7.38 X 1.6000 \$118.08	
56	32 14 11 00-0002	SF	1" To 2" Screeded Sand Bedding	\$66.08
			Qty Unit Price Factor Total	
			Installation 70.000 X \$0.59 X 1.6000 \$66.08	
57	32 14 11 00-0002	0115 MOD	For Up To 100, Add	\$28.00
			Qty Unit Price Factor Total	
			Installation 70.000 X \$0.25 X 1.6000 \$28.00	

CSI Number	Mod	UOM	Description	LineTotal
32 - Exterior Improvements				
58	32 14 13 16-0002	SF	2-3/8" Thick, Up To 32 SI Precast Concrete PaverIncludes 2-1/2" x 5", 4" x 4", 4" x 6", 5" x 5", 4" x 8" and other similar size pavers.	\$1,061.76
			Qty Unit Price Factor Total	
		Installation	70.000 X \$9.48 X 1.6000 \$1,061.76	
59	32 14 13 16-0002	0109 MOD	For Cement/Sand Mix Or Polymeric Sand Joints, Add	\$71.68
			Qty Unit Price Factor Total	
		Installation	70.000 X \$0.64 X 1.6000 \$71.68	
60	32 14 13 16-0002	0115 MOD	For Up To 100, Add	\$358.40
			Qty Unit Price Factor Total	
		Installation	70.000 X \$3.20 X 1.6000 \$358.40	
61	32 96 43 00-0004	EA	>30" To 36" Root Ball, Move Trees On Site	\$1,008.26
			Qty Unit Price Factor Total	
		Installation	2.000 X \$315.08 X 1.6000 \$1,008.26	
Subtotal for 32 - Exterior Improvements:				\$2,712.26
Grand Total:				\$118,527.65

This work order proposal total represents the correct total for the proposal. Any discrepancy between line totals, sub-totals and the proposal total is due to rounding of the line totals and sub-totals.

The Percent of NPP on this Proposal: 0.00



CITY OF RIO COMMUNITIES
RIO COMMUNITIES VETERANS MEMORIAL
 360 RIO COMMUNITIES BLVD.,
 RIO COMMUNITIES, NM 87002

MAY 19, 2026
 100% FOR CONSTRUCTION

DRAWING INDEX

- G001 COVER SHEET
- LD101 DEMOLITION PLAN
- LG101 GRADING PLAN
- LS101 CONSTRUCTION PLAN
- LS501 CONSTRUCTION DETAILS
- LS902 CONSTRUCTION DETAILS
- S0.1 STRUCTURAL NOTES
- S1.1 FOUNDATION PLAN & FOUNDATION DETAILS

DESIGN TEAM:

LANDSCAPE ARCHITECT
 PLAND COLLABORATIVE
 600 1ST ST NW, SUITE 100
 ALBUQUERQUE, NM 87102
 505-268-2266 PH | 505-265-9637 FX
 ATTN: JOHN POPE

OWNER:

CITY OF RIO COMMUNITIES
 360 RIO COMMUNITIES BLVD.,
 RIO COMMUNITIES, NM 87002
 505-961-6803 PH
 ATTN: DR. MARTIN MOORE

VICINITY MAP



PROJECT AREA



plandcollab.com 505 268 2266

CONSULTANTS



PROJECT NAME AND ADDRESS

**RIO COMMUNITIES
 VETERANS
 MEMORIAL**
 360 Rio Communities Blvd., Rio
 Communities, NM 87002

DATE: MAY 19, 2026
 SUBMITTAL: 100% FOR CONSTRUCTION

REVISIONS		
NO.	DATE	DESCRIPTION

PLAND PROJECT NO 26010
 DESIGNED BY SS CHECKED BY JPI/RDL
 DRAWN BY ACJ/KA/SS

SHEET TITLE
COVER SHEET
 SHEET NUMBER
G001



DEMOLITION KEYED NOTES

SYMBOL	CODE	DESCRIPTION
	D-01	REMOVE AND STOCKPILE ALL GRAVEL MATCH FOR FUTURE USE - SEE CONSTRUCTION PLAN LD101 FOR NEW LOCATION. SIFT GRAVEL TO REMOVE FINES OR OTHER UNCLASSIFIED DEBRIS.
	D-02	SAWCUT, REMOVE AND PROPERLY DISPOSE OF CONCRETE VALLEY GUTTER TO THE NEAREST JOINT.
	D-03	REMOVE AND PROPERLY DISPOSE OF EXISTING SHRUBS. REMOVE EMITTER/BUBBLER AND CAP ASSOCIATED IRRIGATION PIPE 2' BELOW FINISH GRADE.
	D-04	REMOVE AND PROPERLY DISPOSE OF EXISTING TREE. GRIND STUMP MINIMUM 2' BELOW FINISH GRADE. FILL AND COMPACT VOID WITH APPROVED FILL MATERIAL. REMOVE EMITTER/BUBBLER AND CAP ASSOCIATED IRRIGATION PIPE 2' BELOW FINISH GRADE. COORDINATE WITH LANDSCAPE ARCHITECT PRIOR TO REMOVAL.
	D-05	EXISTING TREE TO BE DUG UP WITH TREE SPADE AND REPLANTED. SEE CONSTRUCTION PLAN FOR NEW LOCATION.
	D-06	LIMITS OF DISTURBANCE.

EXISTING CONDITION KEYED NOTES

CODE	DESCRIPTION
X-01	EXISTING SHRUBS TO REMAIN.
X-02	EXISTING TREE TO REMAIN. SEE TREE PROTECTION NOTES - THIS SHEET.
X-03	EXISTING CONCRETE WALKWAY TO REMAIN.
X-04	EXISTING VALLEY GUTTER TO REMAIN UNLESS OTHERWISE NOTED.
X-05	EXISTING CATCH BASIN TO REMAIN.
X-06	BUILDING ROOFLINE ABOVE.
X-07	EXISTING BUILDING COLUMN TO REMAIN.
X-08	EXISTING MANHOLE TO REMAIN.

TREE PROTECTION NOTES

CODE	DESCRIPTION
TP-01	CONTRACTOR SHALL ESTABLISH A ROOT PROTECTION ZONE AROUND EACH EXISTING TREE TO REMAIN. THE ROOT PROTECTION ZONE SHALL BE AN AREA DEFINED BY A RADIUS EXTENDING OUTWARD FROM THE TRUNK OF THE TREE A DISTANCE OF ONE LINEAR FEET FOR EACH INCH DIAMETER OF THE TREE. THE TREE DIAMETER SHALL BE MEASURED AT BREAST HEIGHT (4.5' ABOVE FINISH GRADE). EXAMPLE: A 10 INCH DIAMETER TREE WILL HAVE A 10 FOOT RADIUS ROOT PROTECTION ZONE.
TP-02	CONTRACTOR SHALL INSTALL FENCING AT THE PERIMETER OF ROOT PROTECTION ZONES. NO WORK SHALL BEGIN WHERE TREE PROTECTION FENCING HAS NOT BEEN COMPLETED AND APPROVED. TREE PROTECTION FENCING SHALL BE INSTALLED, MAINTAINED AND REPAIRED BY THE CONTRACTOR DURING CONSTRUCTION. THE FENCING SHALL BE A MINIMUM OF 4' HEIGHT.
TP-03	CONTRACTOR SHALL NOT STORE OR DRIVE EQUIPMENT, VEHICLES, OR MATERIALS WITHIN THE ROOT PROTECTION ZONE.
TP-04	CONTRACTOR SHALL PROTECT EXISTING ROOTS FROM DAMAGE WHEN WORKING WITHIN THE ROOT PROTECTION ZONE. THE CONTRACTOR SHALL LIMIT DEMOLITION OR OTHER CONSTRUCTION ACTIVITIES WITHIN THE ROOT PROTECTION ZONE TO THE MINIMUM DISTURBANCE REQUIRED TO COMPLETE CONSTRUCTION.
TP-05	CONTRACTOR SHALL NOT ALLOW CONCRETE TRUCKS TO CLEAN CHUTES OR DUMP EXCESS CONCRETE OR ANY OTHER CEMENTITIOUS PRODUCTS IN ANY PORTION OF THE SITE. CONTRACTOR SHALL CLEAN THE WASTE OF OTHER CEMENTITIOUS MATERIALS FROM THE SURFACE AND THEY SHALL NOT BE TURNED UNDER DURING FINAL GRADING.
TP-06	CONTRACTOR SHALL NOT TRENCH WITHIN THE DRIPLINE OF EXISTING TREES. AT LOCATIONS WHERE IS IT NECESSARY TO INSTALL LINES OR WIRE WITHIN THE DRIPLINE OF EXISTING TREES, THE UTILITY SHALL BE INSTALLED BY HAND OR BY BORING UNDER TREE ROOTS.
TP-07	CONTRACTOR SHALL PROVIDE TEMPORARY WATERING AS REQUIRED TO MAINTAIN THE HEALTH OF THE TREE THROUGHOUT THE DURATION OF CONSTRUCTION OPERATIONS.
TP-08	CONTRACTOR SHALL REVIEW PROPOSED SCOPE OF TREE PROTECTION AND TEMPORARY WATERING WITH LANDSCAPE ARCHITECT PRIOR TO EXECUTION.

GENERAL DEMOLITION NOTES

CODE	DESCRIPTION
00-01	ALL AREAS ADJACENT TO THE SITE SHALL BE MAINTAINED IN A CLEAN CONDITION, MUD AND DUST FREE AT ALL TIMES.
00-02	THERE ARE NO AS-BUILT DRAWINGS AVAILABLE FOR THE EXISTING IRRIGATION SYSTEM. CONTRACTOR SHALL POTENTIALLY AS NECESSARY TO LOCATE IRRIGATION LINES WITHIN LIMITS OF CONSTRUCTION TO AVOID DAMAGE.
00-03	CONTRACTOR SHALL FILL AND COMPACT ALL Voids CREATED BY DEMOLITION WORK WITH CLEAN BACKFILL MATERIAL WHICH SHALL BE APPROVED BY OWNER PRIOR TO BACKFILL OPERATIONS.
00-04	CONTRACTOR SHALL PROTECT EXISTING UTILITIES FROM DAMAGE. ANY DAMAGE TO EXISTING UTILITIES SHALL BE REPAIRED BY THE CONTRACTOR AT NO ADDITIONAL COST TO THE OWNER.
00-05	CONTRACTOR SHALL TAKE ALL NECESSARY PRECAUTIONS TO ENSURE NO DAMAGE OCCURS TO EXISTING STRUCTURES, PAVEMENT TO REMAIN OR ITEMS TO BE SALVAGED. ANY DAMAGE TO ITEMS TO REMAIN OR TO BE SALVAGED RESULTING FROM CONSTRUCTION OPERATIONS SHALL BE REPAIRED AND/OR REPLACED AT NO ADDITIONAL COST TO THE OWNER.
00-06	CONTRACTOR SHALL VISIT THE SITE AND VERIFY ALL EXISTING CONDITIONS PRIOR TO THE BID AND NOTIFY THE OWNER'S REPRESENTATIVE OF ANY DISCREPANCIES, NO ADJUSTMENTS TO THE CONTRACT SUM OR TIME SHALL BE MADE FOR CONDITIONS THAT ARE CLEARLY VISIBLE, YET NOT VERIFIED. FAILURE TO COMPLETE ADEQUATE FIELD VERIFICATION PRIOR TO BID IS DONE SO AT THE CONTRACTOR'S OWN RISK.
00-07	PRIOR TO DEMOLITION OPERATIONS, THE CONTRACTOR SHALL BE REQUIRED TO DOCUMENT ALL EXISTING CONDITIONS DIRECTLY ADJACENT TO THE PROJECT AREA AND THE CONDITION OF ANY EXISTING ITEMS TO REMAIN WITHIN THE PROJECT AREA. CONTRACTOR SHALL PROVIDE DOCUMENTATION TO THE OWNER BEFORE PROCEEDING WITH ANY WORK.
00-08	PRIOR TO DEMOLITION, THE CONTRACTOR SHALL CLEARLY MARK ALL LIMITS OF REMOVAL OF CONCRETE PAVING, ASPHALT, CURBS AND GUTTER, FENCING, ETC. FOR REVIEW AND APPROVAL. MINOR ADJUSTMENTS MAY BE MADE IN THE FIELD TO LIMITS OF REMOVAL TO AVOID REMOVING MORE OF EXISTING ELEMENTS THAN NECESSARY TO CONSTRUCT PROPOSED ELEMENTS.
00-09	TWO WORKING DAYS PRIOR TO ANY EXCAVATION, THE CONTRACTOR SHALL CONTACT NEW MEXICO ONE CALL SYSTEM (1-800-321-2537) FOR LOCATION OF EXISTING UTILITIES.

A1 DEMOLITION PLAN
SCALE: 1"=10'-0"



CONSULTANTS

SEAL

PROJECT NAME AND ADDRESS

RIO COMMUNITIES VETERANS MEMORIAL
350 Rio Communities Blvd., Rio Communities, NM 87002

DATE: MAY 19, 2026
SUBMITTAL: 100% FOR CONSTRUCTION

REVISIONS		
NO.	DATE	DESCRIPTION

PLAND PROJECT NO 26010
DESIGNED BY: SS CHECKED BY: JPR/DL
DRAWN BY: AC/KA/SS

SHEET TITLE: **DEMOLITION PLAN**
SHEET NUMBER: **LD101**

CONSULTANTS



PROJECT NAME AND ADDRESS

**RIO COMMUNITIES
VETERANS
MEMORIAL**
360 Rio Communities Blvd., Rio
Communities, NM 87002

DATE: MAY 19, 2026
SUBMITTAL: 100% FOR CONSTRUCTION

REVISIONS		
NO.	DATE	DESCRIPTION

PLAND PROJECT NO 26010
DESIGNED BY SS CHECKED BY JPR/DL
DRAWN BY ACJ/KASS

SHEET TITLE
**GRADING
PLAN**
SHEET NUMBER
LG101

GRADING GENERAL NOTES

- A. TOP OF NEW CONCRETE, WALKS, PLAZAS, PAVES, ETC. SHALL BE 1" ABOVE TOP OF ADJACENT MULD.
- B. WHERE NEW SIDEWALK ADJUTS EXISTING SIDEWALK, TOP OF NEW SIDEWALK SHALL BE FLUSH WITH TOP OF EXISTING WALK, UNLESS OTHERWISE NOTED ON PLAN.
- C. CONTRACTOR SHALL CONFIRM LOCATIONS AND SHAPING OF SWALE WITH LANDSCAPE ARCHITECT.
- D. CONTRACTOR SHALL VERIFY GRADES WITH LANDSCAPE ARCHITECT PRIOR TO CONSTRUCTION.

GRADING LEGEND

- = SLOPE DIRECTION
- = SPOT ELEVATION (PROPOSED)
- = PROPOSED CONTOURS
- = EXISTING 1' INTERVAL CONTOURS
- = LIMIT OF WORK
- = LIMIT OF DEPRESSION

GRADING ABBREVIATION

- TF = TOP OF FOOTINGS
- TW = TOP OF WALL
- BS = BOTTOM OF STONE
- TS = TOP OF STONE
- TC = TOP OF CONCRETE
- EX = EXISTING GRADE
- TP = TOP OF PAVERS
- FG = FINISHED GRADE

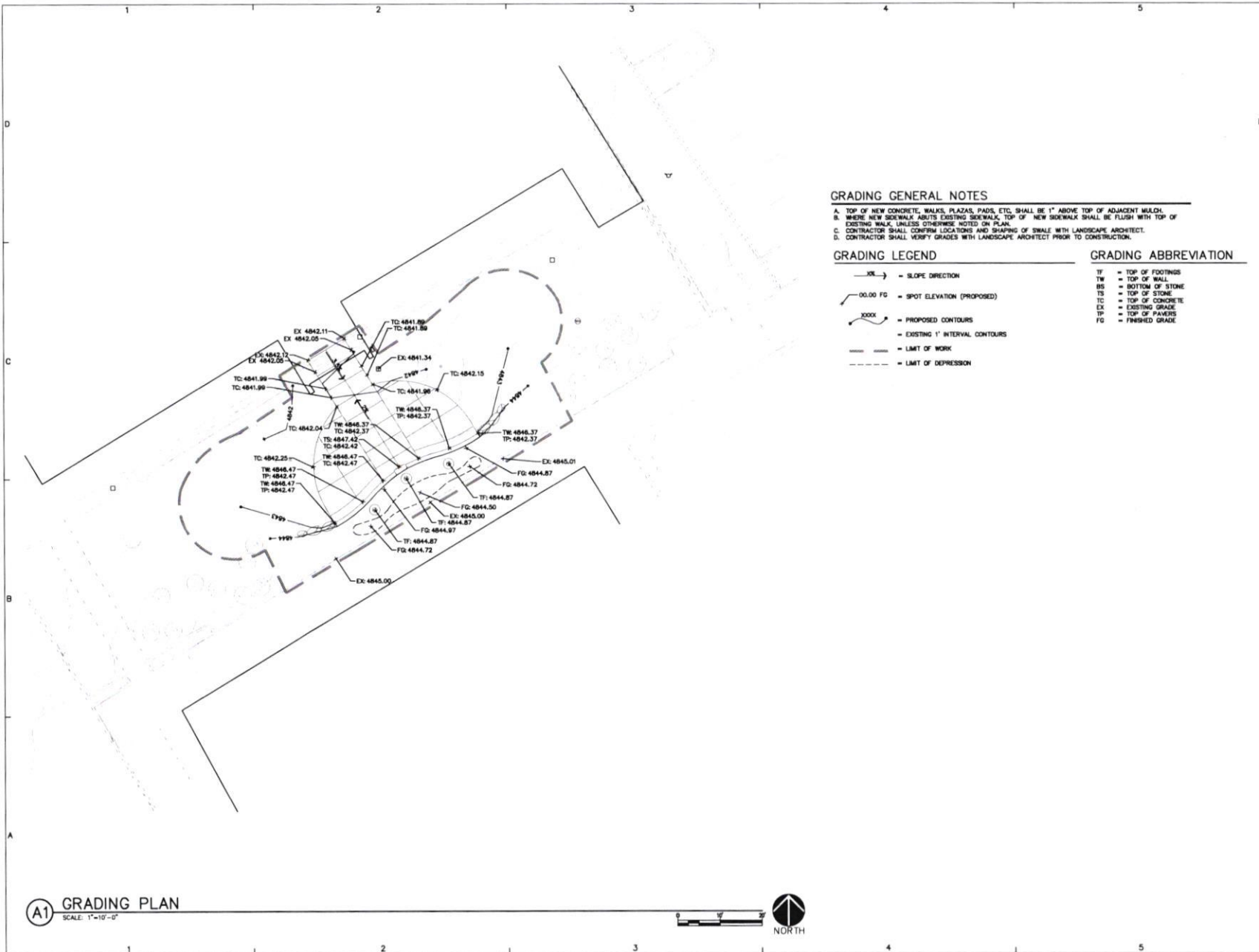

A1 GRADING PLAN
SCALE: 1"=10'-0"

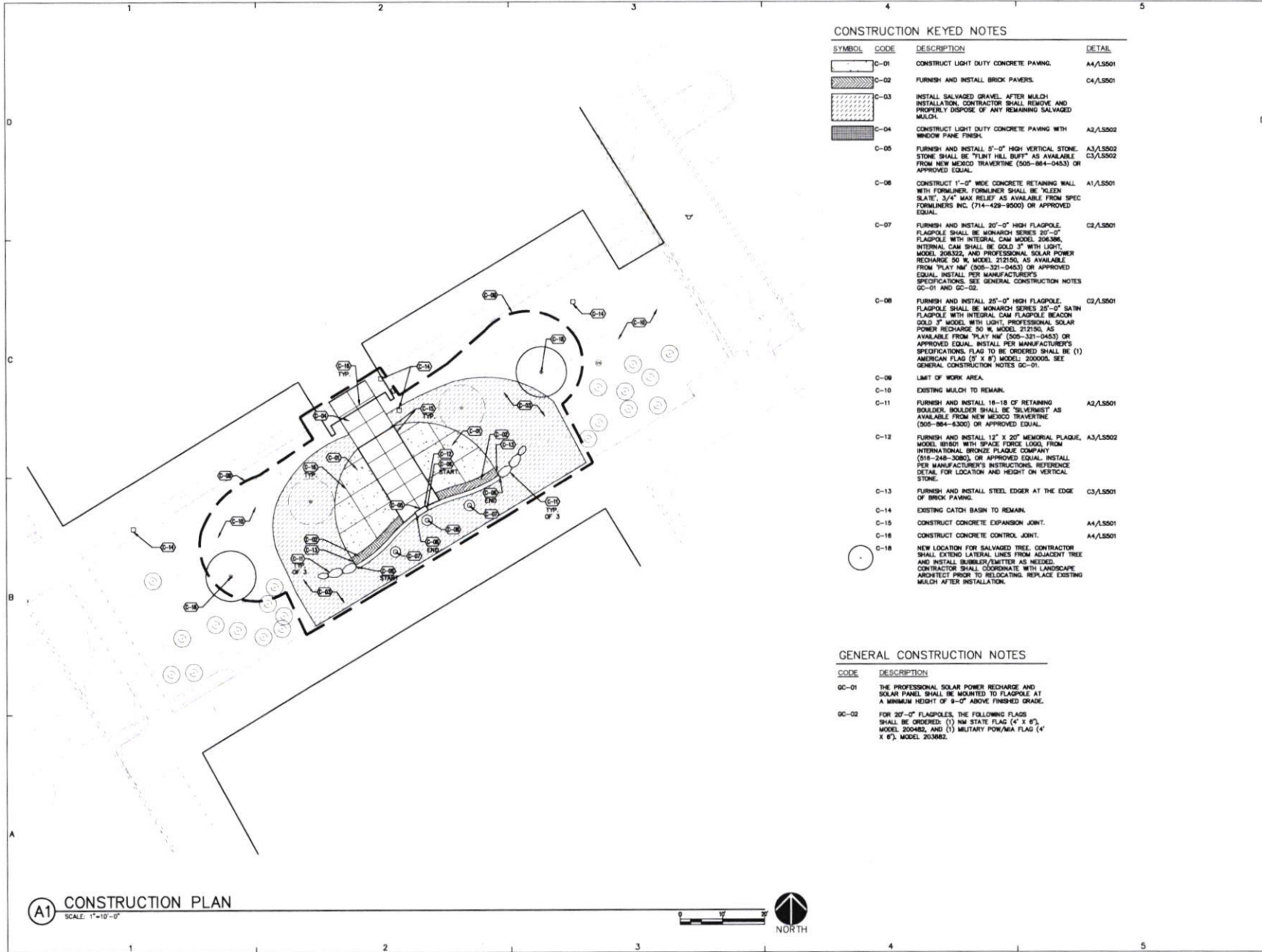

CONSTRUCTION KEYED NOTES

SYMBOL	CODE	DESCRIPTION	DETAIL
	C-01	CONSTRUCT LIGHT DUTY CONCRETE PAVING.	A4/L5501
	C-02	FURNISH AND INSTALL BRICK PAVERS.	C4/L5501
	C-03	INSTALL SALVAGED GRAVEL. AFTER MULCH INSTALLATION, CONTRACTOR SHALL REMOVE AND PROPERLY DISPOSE OF ANY REMAINING SALVAGED MULCH.	
	C-04	CONSTRUCT LIGHT DUTY CONCRETE PAVING WITH WINDOW PANE FINISH.	A2/L5502
	C-05	FURNISH AND INSTALL 5'-0" HIGH VERTICAL STONE. STONE SHALL BE "BLUNT HILL BUFF" AS AVAILABLE FROM NEW MEXICO TRAVERTINE (505-884-0453) OR APPROVED EQUAL.	A3/L5502 C3/L5502
	C-06	CONSTRUCT 1'-0" WIDE CONCRETE RETAINING WALL WITH FORMLINER. FORMLINER SHALL BE "KLEEN SLATE," 3/4" MAX RELIEF AS AVAILABLE FROM SPEC FORMLINERS INC. (714-429-8000) OR APPROVED EQUAL.	A1/L5501
	C-07	FURNISH AND INSTALL 20'-0" HIGH FLAGPOLE. FLAGPOLE SHALL BE MONARCH SERIES 20'-0" FLAGPOLE WITH INTEGRAL CAM MODEL 206386. INTERNAL CAM SHALL BE GOLD 3" WITH LIGHT MODEL 206322, AND PROFESSIONAL SOLAR POWER RECHARGE 50 W. MODEL 212150, AS AVAILABLE FROM "PLAY NW" (505-321-0453) OR APPROVED EQUAL. INSTALL PER MANUFACTURER'S SPECIFICATIONS. SEE GENERAL CONSTRUCTION NOTES GC-01 AND GC-02.	C2/L5501
	C-08	FURNISH AND INSTALL 25'-0" HIGH FLAGPOLE. FLAGPOLE WITH INTEGRAL CAM FLAGPOLE BEACON GOLD 3" MODEL WITH LIGHT, PROFESSIONAL SOLAR POWER RECHARGE 50 W. MODEL 212150, AS AVAILABLE FROM "PLAY NW" (505-321-0453) OR APPROVED EQUAL. INSTALL PER MANUFACTURER'S SPECIFICATIONS. FLAG TO BE ORDERED SHALL BE (1) AMERICAN FLAG (5' X 8') MODEL 20000A. SEE GENERAL CONSTRUCTION NOTES GC-01.	C2/L5501
	C-09	LIMIT OF WORK AREA.	
	C-10	EXISTING MULCH TO REMAIN.	
	C-11	FURNISH AND INSTALL 18"-18" OF RETAINING BOLLARD. BOLLARD SHALL BE "SERVIENT" AS AVAILABLE FROM NEW MEXICO TRAVERTINE (505-884-0300) OR APPROVED EQUAL.	A2/L5501
	C-12	FURNISH AND INSTALL 12" X 20" MEMORIAL PLAQUE, MODEL 81801 WITH SPACE FORCE LOGO, FROM INTERNATIONAL BRONZE PLAQUE COMPANY (918-248-3080), OR APPROVED EQUAL. INSTALL PER MANUFACTURER'S INSTRUCTIONS. REFERENCE DETAIL FOR LOCATION AND HEIGHT ON VERTICAL STONE.	A3/L5502
	C-13	FURNISH AND INSTALL STEEL EDGER AT THE EDGE OF BRICK PAVING.	C3/L5501
	C-14	EXISTING CATCH BASIN TO REMAIN.	
	C-15	CONSTRUCT CONCRETE EXPANSION JOINT.	A4/L5501
	C-16	CONSTRUCT CONCRETE CONTROL JOINT.	A4/L5501
	C-18	NEW LOCATION FOR SALVAGED TREE. CONTRACTOR SHALL EXTEND LATERAL LINES FROM ADJACENT TREE AND INSTALL SUBBLER/EMITTER AS NEEDED. CONTRACTOR SHALL COORDINATE WITH LANDSCAPE ARCHITECT PRIOR TO RELOCATING. REPLACE EXISTING MULCH AFTER INSTALLATION.	

GENERAL CONSTRUCTION NOTES

CODE	DESCRIPTION
GC-01	THE PROFESSIONAL SOLAR POWER RECHARGE AND SOLAR PANEL SHALL BE MOUNTED TO FLAGPOLE AT A MINIMUM HEIGHT OF 8'-0" ABOVE FINISHED GRADE.
GC-02	FOR 20'-0" FLAGPOLES, THE FOLLOWING FLAGS SHALL BE ORDERED: (1) NEW STATE FLAG (4' X 6'), MODEL 200482, AND (1) MILITARY POW/MIA FLAG (4' X 6'), MODEL 203882.



plandcollab.com 505 268 2266

CONSULTANTS



PROJECT NAME AND ADDRESS

RIO COMMUNITIES VETERANS MEMORIAL
360 Rio Communities Blvd., Rio Communities, NM 87002

DATE: MAY 19, 2026
SUBMITTAL: 100% FOR CONSTRUCTION

NO.	DATE	DESCRIPTION

PLAND PROJECT NO 26010
DESIGNED BY SS CHECKED BY JPR/DL
DRAWN BY AC/KASS

SHEET TITLE
CONSTRUCTION PLAN
SHEET NUMBER
LS101

CONSULTANTS

SEAL



PROJECT NAME AND ADDRESS

**RIO COMMUNITIES
VETERANS
MEMORIAL**
360 Rio Communities Blvd., Rio
Communities, NM 87002

DATE: MAY 19, 2026
SUBMITTAL: 100% FOR CONSTRUCTION

REVISIONS	
NO.	DESCRIPTION

PLAND PROJECT NO 26010
DESIGNED BY 55 CHECKED BY JPR/DL
DRAWN BY AC/KAV/SS

SHEET TITLE

**CONSTRUCTION
DETAILS**

SHEET NUMBER
LS501

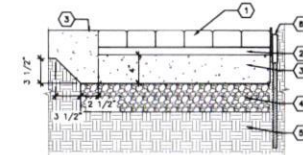

KEYED NOTES

- BRICK PAVERS - SEE PLAN. BRICK PAVERS SHALL BE "DESERT MIRAQ" AS AVAILABLE FROM KINNEY BRICK (505-877-4550).
- 1" DEPTH CONCRETE SAND LEVELING COURSE.
- 4" DEPTH CONCRETE PAVING - SEE PLAN.
- 4" DEPTH COMPACTED BASE COURSE, HMDOT TYPE I.
- SUBGRADE COMPACTED TO 95%.
- STEEL EDGING, SEE PLAN.

GENERAL NOTES

- REFERENCE PLAN FOR PAVES TYPE, COLOR, INSTALLATION PATTERN AND ORIENTATION.
- WHERE PAVERS ABUT CONTAINMENT EDGE AND OTHER HARD CONSTRUCTION, PAVERS SHALL BE CLEARLY SAWCUT AS REQUIRED TO FIT.
- TOP OF PAVERS SHALL BE INSTALLED FLUSH WITH TOP OF ADJACENT PAVEMENT.
- AFTER PLACING PAVERS ON SAND LEVELING COURSE, SWEEP DRY CONCRETE SAND INTO PAVES JOINTS AND VIBRATE WITH A PLATE COMPACTOR TO VIBRATE SAND INTO JOINTS. THESE STEPS SHALL BE REPEATED UNTIL ALL PAVES JOINTS ARE FILLED WITH CONCRETE SAND. UPON COMPLETION, SWEEP OFF EXCESS SAND.
- ALL JOINT LINES SHALL NOT DEVIATE MORE THAN 1/2" OVER 50' FROM STRING LINES.
- PROVIDE JOINTS BETWEEN PAVERS 1/4" AND 3/8" WIDE, NO MORE THAN 5% OF THE JOINTS SHALL EXCEED 1/4" WIDE TO ACHIEVE STRAIGHT BOND LINES.
- FINAL SURFACE TOLERANCE FROM GRADE ELEVATIONS SHALL NOT DEVIATE MORE THAN 1/4" UNDER A 10' STRAIGHT EDGE.
- ALL PAVERS SHALL HAVE NO GREATER THAN 1/8" DIFFERENCE IN HEIGHT BETWEEN ADJACENT PAVERS.
- ALL PAVES JOINT LINES SHALL BE TRUE PARALLEL AND PERPENDICULAR TO EDGE OF ADJACENT HARD CONSTRUCTION.
- REFERENCE MANUFACTURER'S GUIDELINES FOR ADDITIONAL INSTALLATION REQUIREMENTS.

C4 BRICK PAVERS ON CONCRETE SLAB

1 1/2' - 1'-0"

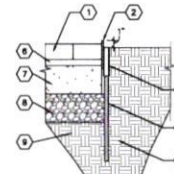

KEYED NOTES

- BRICK PAVERS - SEE PLAN.
- 1/4" X 4" ROLLED STEEL FLAT BAR, BUTT JOINTS SHALL BE FIELD WELDED AND GROUND SMOOTH. COLOR SHALL BE BLACK.
- #4 REBAR STAKE, 18" LENGTH, DRIVEN THROUGH STEEL TUBE. INSTALL (3) STAKES EVENLY SPACED ALONG FULL LENGTH.
- SUBGRADE.
- 3/4" DIAMETER X 4" LENGTH STEEL TUBE WELDED TO FLAT BAR AT 48" O.C. AND 4" FROM ALL ENDS.
- 1" DEPTH CONCRETE SAND LEVELING COURSE.
- 4" DEPTH 3000 PSF CONCRETE PAVING.
- 4" DEPTH OF COMPACTED BASE COURSE.
- SUBGRADE COMPACTED TO 95%.

C3 STEEL EDGING PAVES RESTRAINT

1 1/2' - 1'-0"

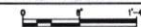

KEYED NOTES

- GOLD ANODIZED SPUN ALUMINUM BALL, FLUSH SEAM.
- DOUBLE SHEAVE TRUCK, CAST ALUMINUM, REVOLVING NON-FOLDING TYPE.
- FOUR SHIMEL SHAPS.
- TWO SETS OF HAYWARDS.
- 6" CAST ALUMINUM CLEAT.
- ALUMINUM FLASH COLLAR.
- DRY SAND TIGHTLY TAMPED AFTER ALIGNING POLE.
- FOUNDATION SLEEVE HOT DP GALVANIZED STEEL.
- HARDWOOD WEDGES.
- STEEL BASE PLATE.
- STEEL SUPPORT PLATE WELDED TO GROUND SPIKE.
- 3000 PSF CONCRETE FOOTING - SLOPE AWAY FROM THE CENTER.
- LANDSCAPE AREA, SEE PLANS.
- SUBGRADE COMPACTED TO 95%.
- GROUNDING ROD.

GENERAL NOTES

- DIMENSIONS OF FOOTING TO BE PROVIDED BY FLAGPOLE MANUFACTURER BASED ON HEIGHT OF POLE.

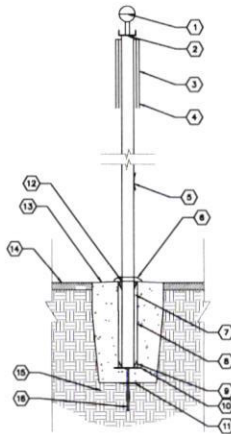

C2 FLAGPOLE

1 1/2' - 1'-0"

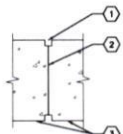
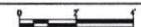

KEYED NOTES

- 1/2" SQUARE CHAMFER, TYP.
- COLD JOINT WITH 1/4" RADIUS TOOLED EDGES ON TOP OF WALL.
- CONCRETE WALL - SEE PLAN.

C1 CONCRETE WALL COLD JOINT

3' - 1'-0"

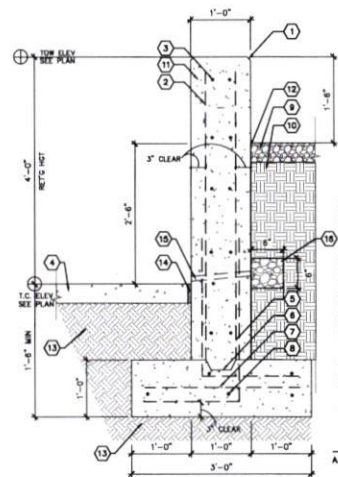
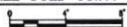

KEYED NOTES

- 3/4" CHAMFER, TYP.
- #4 REBAR AT 12" O.C. VERTICAL EF.
- #4 REBAR AT 12" O.C. HORIZONTAL EF.
- CONCRETE PAVING.
- #4 REBAR AT 12" O.C.
- 2" X 4" KEYWAY.
- #4 TRANSVERSE AT 12" O.C.
- 5 - #4 REBARS CONTINUOUS.
- 4" DEPTH GRAVEL.
- UNCOMPACTED SUBGRADE.
- 3000 PSF CONCRETE.
- APPLY HYDROXIDE 700B EMULSIFIED ASPHALT DAMP-PROOFING OR APPROVED EQUAL.
- SUBGRADE COMPACTED TO 95%.
- 1/2" EXPANSION JOINT.
- 1/2" DIAMETER PVC WEEP HOLE. INSTALL AT 48" O.C.
- 3/4" WASHED GRAVEL WRAPPED WITH FABRIC.

GENERAL NOTES

- INSTALL CONCRETE WALL COLD JOINT EVERY 16' PER DETAIL C1/S501.

A1 4' HEIGHT RETAINING WALL

1' - 1'-0"

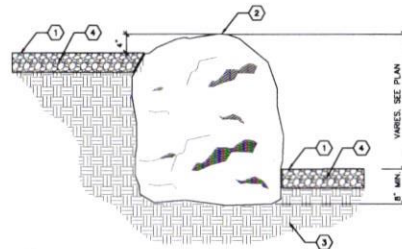
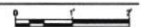

KEYED NOTES

- FINISH GRADE.
- BOULDER - SEE PLAN.
- COMPACTED SUBGRADE.
- 4" DEPTH GRAVEL.

GENERAL NOTES

- WHEN MULTIPLE BOULDERS ARE SHOWN ABUTTING EACH OTHER, SPACING BETWEEN SHALL BE MINIMIZED TO PREVENT DISPLACEMENT OF MULCH AND SOIL BACKFILL.

A2 RETAINING BOULDER

NOT TO SCALE

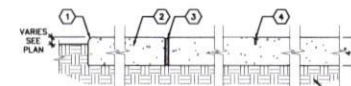

KEYED NOTES

- TOOLED EDGE, 1/2" RADIUS.
- 3000 PSF CONCRETE.
- 1/2" WIDE EXPANSION JOINT WITH FELT EXPANSION MATERIAL.
- 1/8" X 1" CONTROL JOINT.
- SUBGRADE COMPACTED TO 95%.

GENERAL NOTES

- CONTROL JOINTS SHALL BE AT MAXIMUM EVERY 10' OR AS SHOWN ON PLAN.
- EXPANSION JOINTS SHALL BE AT MAXIMUM EVERY 30' OR AS SHOWN ON PLAN AND WHERE PAVING ABUTS EXISTING BUILDINGS, CURBS, SEATING WALLS, WALKS AND OTHER HARD CONSTRUCTION.
- FELT EXPANSION MATERIAL SHALL BE RECESSED 1/2" AND SET WITH PLASTIC EXPANSION JOINT CAP. TOP OF CAP SHALL BE FLUSH WITH TOP OF CONCRETE. OPPOSING CONCRETE EDGES OF JOINT SHALL HAVE 1/4" RADIUS TOOLED EDGE.
- CONTROL JOINTS SHALL BE TOOLED OR SAW CUT TO INDICATED DEPTH. SAW CUT JOINTS SHALL BE CUT WITHIN 24 HOURS AFTER FINISHING OF CONCRETE USING A SOFT-CUT WET SAW. SPALLING OF CONCRETE FINISH AT EDGE OF CUT IS NOT ACCEPTABLE.
- PROVIDE MEDIUM BROOM FINISH UNLESS OTHERWISE NOTED ON THE PLANS.

A4 LIGHT-DUTY CONCRETE PAVING

1 1/2' - 1'-0"



CONSULTANTS



PROJECT NAME AND ADDRESS

RIO COMMUNITIES VETERANS MEMORIAL
360 Rio Communities Blvd., Rio Communities, NM 87002

DATE: MAY 19, 2026
SUBMITTAL: 100% FOR CONSTRUCTION

REVISIONS

NO.	DATE	DESCRIPTION

PLAND PROJECT NO 26010
DESIGNED BY SS CHECKED BY JPR/DL
DRAWN BY AC/KA/SS

SHEET TITLE

CONSTRUCTION DETAILS

SHEET NUMBER
LS502

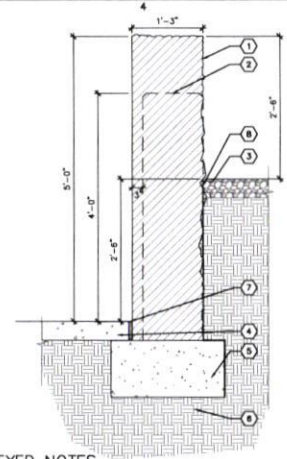

- KEYED NOTES**
1. VERTICAL STONE - SEE PLAN.
 2. CONCRETE RETAINING WALL - SEE PLAN.
 3. 4" DEPTH GRAVEL - SEE PLAN.
 4. CONCRETE PAVING - SEE PLAN.
 5. FOOTING FOR VERTICAL STONE - SEE STRUCTURAL PLANS.
 6. SUBGRADE COMPACTED TO BISE.
 7. 1/2" EXPANSION JOINT.
 8. FILTER FABRIC: EXTEND 3'-0" FROM EITHER SIDES OF THE VERTICAL STONE.

C3 VERTICAL STONE WALL SECTION
1" = 1'-0"

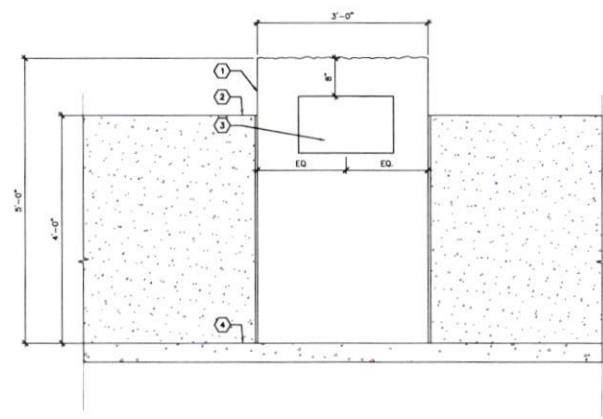

- KEYED NOTES**
1. VERTICAL STONE - SEE PLAN.
 2. CONCRETE RETAINING WALL - SEE PLAN.
 3. MEMORIAL PLAQUE MOUNTED ON STONE - SEE PLAN.
 4. FINISHED GRADE - SEE PLAN.

GENERAL NOTES

A. AFTER CONCRETE RETAINING WALLS ARE POURED, CONTRACTOR SHALL COORDINATE WITH NEW MEXICO TRAVERTINE THE FINAL WIDTH OF VERTICAL STONE.

A3 VERTICAL STONE ELEVATION
1" = 1'-0"

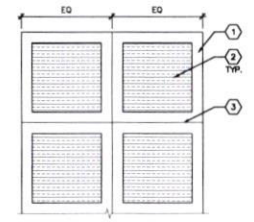

- KEYED NOTES**
1. 6" WIDE TROWLED EDGE.
 2. MEDIUM BROOM FINISH PERPENDICULAR TO FLOW OF TRAFFIC.
 3. CONTROL JOINT - SEE PLAN.

GENERAL NOTES

A. FOR CONCRETE PAVING - AA/LS502.
B. FOR EXPANSION JOINTS - SEE PLAN.

A2 CONCRETE PAVING PATTERN
3/8" = 1'-0"

STRUCTURAL NOTES

GENERAL

1. THE CONTRACT STRUCTURAL DRAWINGS AND SPECIFICATIONS REPRESENT THE FINISHED STRUCTURE. THEY DO NOT INDICATE THE MEANS OR METHOD OR SEQUENCE OF CONSTRUCTION.
2. THE CONTRACTOR IS RESPONSIBLE FOR SAFETY PRECAUTIONS AND PROGRAMS IN CONNECTION WITH THE WORK THAT CONFORMS WITH THE REGULATIONS OF THE OCCUPATIONAL SAFETY AND HEALTH ADMINISTRATION (OSHA) SAFETY AND HEALTH STANDARDS FOR THE CONSTRUCTION INDUSTRY.
3. CONSTRUCTION MATERIALS SHALL BE SPREAD OUT IF PLACED ON THE STRUCTURE SO AS NOT TO EXCEED THE DESIGN LIVE LOAD PER SQUARE FOOT.
4. WHERE REFERENCE IS MADE TO VARIOUS TEST STANDARDS FOR MATERIALS, SUCH STANDARDS SHALL BE THE LATEST EDITION AND/OR ADDENDUM.
5. ESTABLISH AND VERIFY ALL OPENINGS, INSERTS, OR EQUIPMENT FOR ARCHITECTURAL, MECHANICAL, ELECTRICAL, AND PLUMBING WITH APPROPRIATE TRADE. IT IS THE GENERAL CONTRACTOR'S RESPONSIBILITY TO COORDINATE WITH THE SUBCONTRACTORS AND EQUIPMENT SUPPLIERS. EQUIPMENT BEING SUPPORTED BY OR SUSPENDED FROM THE STRUCTURE SHALL BE COORDINATED WITH THE MANUFACTURER OF ANY PRE-ENGINEERED FRAMING OR COMPONENTS. ALL OPENINGS SHALL BE PROPERLY REINFORCED AS APPROVED BY THE ENGINEER. DO NOT PENETRATE ANY STRUCTURAL ELEMENTS (BEAMS, COLUMNS, WALLS, STEEL DECK, SLABS, ETC.) WITHOUT PRIOR WRITTEN APPROVAL OF THE ENGINEER OF RECORD THROUGH THE ARCHITECT.
6. CONTRACTOR SHALL VERIFY ALL DIMENSIONS AND COORDINATE SITE CONDITIONS WITH THE DRAWINGS PRIOR TO CONSTRUCTION. ANY DISCREPANCIES AND OMISSIONS SHALL BE RESOLVED WITH THE ARCHITECT PRIOR TO CONSTRUCTION AND PRIOR TO PROCEEDING. DO NOT USE SCALED DIMENSIONS.
7. WHERE ANY DISCREPANCIES OCCUR BETWEEN PLANS, DETAILS, STRUCTURAL NOTES AND SPECIFICATIONS, THE GREATER REQUIREMENTS SHALL GOVERN.
8. TYPICAL DETAILS MAY OR MAY NOT BE CUT ON THE DRAWINGS, AND DETAILS MAY OR MAY NOT BE CUT AT ALL SPECIFIC LOCATIONS, BUT SHALL APPLY UNLESS NOTED OTHERWISE.
9. APPROVED EQUAL OPTIONS ARE FOR THE CONTRACTOR'S CONVENIENCE AND ARE SUBJECT TO APPROVAL BY THE ARCHITECT. IF AN OPTION IS CHOSEN, THE CONTRACTOR SHALL BE RESPONSIBLE FOR ALL CHANGES AND COSTS NECESSARY AND FOR COORDINATION OF ALL DETAILS AS REQUIRED TO INCORPORATE THE OPTION INTO THE WORK.
10. ANY ENGINEERING DESIGN PROVIDED BY OTHERS AND SUBMITTED FOR REVIEW SHALL BEAR THE SEAL OF A PROFESSIONAL ENGINEER REGISTERED IN THE STATE WHICH THE PROJECT IS LOCATED.

LIMITATION OF LIABILITY

1. UNITY ENGINEERING, PC IS NOT LIABLE FOR ANY ASPECTS OF THE STRUCTURE WHICH ARE NOT SPECIFICALLY SHOWN ON THE STRUCTURAL DOCUMENTS. IN THE EVENT A BUILDING ELEMENT IS NOT SHOWN ON THESE STRUCTURAL DOCUMENTS, THE CONTRACTOR SHALL BE RESPONSIBLE TO EITHER PROVIDE A DESIGN BY A REGISTERED ENGINEER OR TO INFORM UNITY ENGINEERING, PC TO PROVIDE THE DESIGN AND/OR APPROVAL.
2. ALL IMPOSED LOADS, WHICH EXCEED 300 POUNDS SUSPENDED FROM OR PLACED ON TOP OF ANY ROOF MEMBER ARE NOT ALLOWED WITHOUT SPECIFIC APPROVAL BY UNITY ENGINEERING, PC UNLESS SUCH LOADS ARE SPECIFICALLY SHOWN ON THE STRUCTURAL DOCUMENTS. SUCH LOADS INCLUDE, BUT ARE NOT LIMITED TO: LIGHTS, SOFFITS, PARTITIONS, MECHANICAL EQUIPMENT, PROCESS PIPING, MECHANICAL PIPING, ELECTRICAL EQUIPMENT, CEILING FEATURES, ETC.

CODE AND DESIGN LOADS

1. ALL CONSTRUCTION SHALL CONFORM TO THE 2021 EDITION OF THE INTERNATIONAL BUILDING CODE.
2. GRAVITY
DEAD LOAD = SELF WEIGHT
SNOW LOAD = 20 PSF
3. WIND
BASIC WIND SPEED = 110MPH
EXPOSURE = "C"
4. IMPORTANCE FACTOR = 1.0
5. SEISMIC
CLASSIFICATION OF BUILDING - II
SEISMIC USE GROUP - I
SPECTRAL RESPONSE COEFFICIENTS
SDS = 0.419
SD1 = 0.204
SITE CLASS - "D"
SEISMIC DESIGN CATEGORY - "D"

FOUNDATIONS

1. ALL SLABS AND FOOTINGS SHALL BEAR ON FIRM UNDISTURBED NATIVE SOIL. ALL SOIL BELOW FOOTINGS AND SLABS SHALL BE COMPACTED TO 90% MINIMUM IN ACCORDANCE TO ASTM D698. DESIGN SOIL BEARING PRESSURE = 1500 PSF AT 1'-6" BELOW LOWEST ADJACENT FINISHED GRADE PER MINIMUM VALUES IN I.B.C. TABLE 1806.2
2. ALL CONSTRUCTION SHALL COMPLY WITH THE MINIMUM REQUIREMENTS. THE ENGINEER OF RECORD IS NOT RESPONSIBLE FOR ANY GEOTECHNICAL ASPECTS OF THIS PROJECT AND THE CONTRACTOR SHALL HIRE A GEOTECHNICAL ENGINEER IF UNSUAL/UNSATURABLE MATERIAL/SOIL IS DISCOVERED DURING EXCAVATIONS/CONSTRUCTION.
3. ABANDONED FOOTINGS, NEW OR EXISTING UTILITIES, ETC. THAT INTERFERE WITH NEW CONSTRUCTION SHALL BE REROUTED OR REMOVED AS COORDINATED WITH THE ARCHITECT AND AS DIRECTED BY A LICENSED GEOTECHNICAL ENGINEER.
4. ALL EXTERIOR FINISHED GRADES SHALL SLOPE AWAY FROM THE BUILDING TO ENSURE NO PONDING OF WATER OCCURS AROUND BUILDINGS.

CAST-IN-PLACE CONCRETE

1. CONCRETE WORK SHALL CONFORM TO ALL REQUIREMENTS OF ACI 301 SPECIFICATIONS FOR STRUCTURAL CONCRETE FOR BUILDINGS AND ACI 318, "BUILDING CODE REQUIREMENTS FOR REINFORCED CONCRETE".
2. ADDITION OF WATER TO THE BATCH FOR MATERIAL WITH INSUFFICIENT SLUMP WILL NOT BE PERMITTED. UNLESS THE SUPPLIER HAS SPECIFICALLY WITHHELD WATER FROM THE BATCH AT THE PLANT, IN NO CASE SHALL THE MAX. DESIGN AND TRUCK TICKET MUST CLEARLY STATE THE MAXIMUM AMOUNT OF WATER THAT CAN BE ADDED TO THE BATCH ON SITE. IN NO CASE SHALL THE DESIGN WATER TO CEMENTITIOUS MATERIAL RATIO BE EXCEEDED.
3. CONCRETE SHALL BE READY MIXED CONCRETE IN ACCORDANCE WITH ASTM C84 CONCRETE USE
MINIMUM 28 DAY COMPRESSIVE STRENGTH
3,000 PSI
SLABS ON GRADE - 3,000 PSI (DESIGNED FOR 2500 PSI)
FOUNDATIONS - 3,000 PSI (DESIGNED FOR 2500 PSI)
4. CEMENT SHALL CONFORM TO ASTM C150, TYPE II. AGGREGATE PER ASTM C33. LIGHTWEIGHT AGGREGATE PER ASTM C330. MAXIMUM 5" SLUMP FOR ALL CONCRETE. CONCRETE CONTAINING SUPERPLASTICIZING ADMIXTURE SHALL HAVE 8" MAXIMUM SLUMP AT PLACEMENT. MIX DESIGNS SHALL BE DESIGNED BY THE CONCRETE PRODUCTION FACILITY IN ACCORDANCE WITH ACI 301 AND APPROVED BY THE ENGINEER OF RECORD PRIOR TO CONSTRUCTION.
5. CONCRETE SHALL BE FREE OF CHLORIDE. WHEN USED, FLY ASH SHALL CONFORM TO ASTM C618, CLASS F. FLY ASH SHALL NOT REPLACE MORE THAN 20% OF CEMENT BY WEIGHT.
6. CONCRETE SHALL NOT BE DROPPED MORE THAN FIVE FEET VERTICALLY WITHOUT USE OF TREMIES.
7. CONCRETE FOOTINGS AND SLAB/FINISHS MAY BE POURED AGAINST NEAT EXCAVATIONS PROVIDED THAT FOOTING DIMENSION ARE ADHERED TO, AND THE REQUIRED CONCRETE COVERAGE FOR REINFORCING IS MAINTAINED.
8. PROVIDE SLEEVES FOR UTILITY OPENINGS IN CONCRETE BEFORE PLACING CONCRETE. DO NOT CUT ANY CONFLICTING REINFORCING.
9. PROVIDE 3/4" CHAMFER ON ALL EXPOSED EDGES OF BEAMS, COLUMNS, WALLS, ETC., U.N.O.
10. MECHANICALLY VIBRATE ALL CONCRETE WHEN PLACED. EXCEPT SLABS ON GRADE, 4" INCHES OR LESS IN THICKNESS, NEED BE VIBRATED ONLY AT AREA OF REINFORCEMENT EMBEDDED ITEMS, THICKENED AREA, AND ADJACENT TO PENETRATIONS.
11. CAST CLOSURE POUR AROUND COLUMNS AFTER COLUMN DEAD LOAD IS APPLIED.
12. CONCRETE WHICH HAS CONTAINED WATER FOR MORE THAN 90 MINUTES (60 MINUTES IF AIR TEMPERATURE EXCEEDS 85DEGREES) SHALL NOT BE USED. RETEMPERING OF CONCRETE AFTER INITIAL SET HAS OCCURRED IS NOT PERMITTED.
13. CURE EXPOSED CONCRETE FOR A MINIMUM OF 7 DAYS IN ACCORDANCE WITH ACI 301 PROCEDURES IN ORDER TO PREVENT CRACKING. CURE WITH CURING AND SEALING COMPOUND. MOIST CURING, MOISTURE-RETAINING COVER CURING, OR COMBINATIONS THEREOF, IF CURING COMPOUND IS USED, APPLY AT A RATE SPECIFIED BY THE MANUFACTURER.
14. CONCRETE COMPRESSIVE STRENGTH AND SLUMP SHALL BE TESTED PER ASTM C31, C39 AND C143. PROVIDE 3 CYLINDERS PER TEST FOR EACH DAY'S CONCRETE PLACEMENT OR AS DIRECTED BY THE ENGINEER. TEST ONE CYLINDER AT 7 DAYS AND TWO AT 28 DAYS. TESTING SHALL BE DONE BY A QUALIFIED TESTING LABORATORY.
15. ALL HOT WEATHER CONCRETING SHALL MEET THE REQUIREMENTS OF ACI 305, AND ACI 308 FOR COLD WEATHER CONCRETING.
16. THE ENGINEER OF RECORD IS NOT AN EXPERT IN THE FIELD OF CONCRETE MOISTURE AND IS NOT RESPONSIBLE FOR ANY ISSUES THAT MAY OCCUR/ARISE FROM BELOW SLAB MOISTURE THAT MAY ENTER THE SLAB (HOW THAT MAY AFFECT FLOORING, INTERIOR NON-BEARING WALLS, ETC.). IT IS THE CONTRACTOR/OWNER'S RESPONSIBILITY TO HIRE A GEOTECHNICAL ENGINEER TO ADVISE ON THE POSSIBLE USE OF A VAPOR BARRIER, CONCRETE ADMIXTURE, ETC.

REINFORCING STEEL

1. ALL REINFORCING STEEL SHALL BE DETAILED AND PLACED IN CONFORMANCE WITH THE LATEST EDITIONS OF ACI 318 AND THE CRSI "MANUAL OF STANDARD PRACTICE FOR REINFORCED CONCRETE CONSTRUCTION", AND AS MODIFIED BY THE DRAWINGS. ALL REINFORCING BAR BENDS SHALL BE MADE COLD.
2. REINFORCING STEEL SHALL CONFORM TO ASTM A615, GRADE 60 (FY = 60 KSI) DEFORMED BARS FOR ALL BARS #4 AND LARGER. ASTM A615, GRADE 40 (FY = 40 KSI) DEFORMED BARS FOR ALL BARS #4 AND SMALLER. REINFORCING TO BE WELDED SHALL CONFORM TO ASTM A706, GRADE 60 (FY = 60 KSI) LOW ALLOY DEFORMED BARS. WELDING OF REINFORCING SHALL BE ACCORDING TO AWS D1.4. NO TACK WELDING OF REINFORCING BARS ALLOWED.
3. ALL REINFORCING STEEL SHALL BE ACCURATELY PLACED AND SUPPORTED BY GALVANIZED METAL OR PLASTIC CHAIRS, SPACERS OR HANGERS. PROVIDE THE FOLLOWING MINIMUM CLEAR CONCRETE COVERAGE:
CAST AGAINST AND PERMANENTLY EXPOSED TO EARTH - 3" EXPOSED TO EARTH OR WEATHER
#6 AND LARGER - 2"
#5 AND SMALLER - 1 1/2"
COLUMNS (TO TIES) - 1 1/2"
BEAMS (TO STIRRUPS) - 1 1/2"
ALL OTHERS PER LATEST EDITION OF ACI 318
4. LAP SPLICES IN CONCRETE SHALL BE 48 BAR DIAMETERS (24" MINIMUM). STAGGER ALTERNATE SPLICES A MINIMUM OF ONE LAP LENGTH. ALL SPLICE LOCATIONS SUBJECT TO APPROVAL AND SHALL BE MADE ONLY WHERE INDICATED ON THE DRAWINGS. EXTEND ALL HORIZONTAL REINFORCING CONTINUOUS AROUND CORNERS AND INTERSECTIONS OR PROVIDE BENT CORNER BARS TO MATCH AND LAP WITH HORIZONTAL BARS AT CORNERS AND INTERSECTIONS OF FOOTINGS AND WALLS.
5. REINFORCING BAR SPACING GIVEN ARE MAXIMUM ON CENTERS. DOWEL ALL VERTICAL REINFORCING TO FOUNDATION. SKEW HOOKS AS REQUIRED FOR CONCRETE COVER. SECURELY TIE ALL BARS IN POSITION BEFORE PLACING CONCRETE. CONCRETE COLUMN DOWEL EMBEDMENT SHALL BE A STANDARD COMPRESSION DOWEL EMBEDMENT LENGTH PER THE LATEST EDITION OF ACI 318.
6. SPLICE BARS SHALL BE PLACED AT THE SAME EFFECTIVE DEPTH UNLESS NOTED OTHERWISE. REINFORCING BARS NOTED "CONTINUOUS" OR WITH LENGTH NOT SHOWN SHALL BE FULLY CONTINUOUS AND SPLICED ONLY AS SHOWN, OR WHERE APPROVED BY THE ENGINEER.
7. REINFORCING BAR HOOKS SHALL BE STANDARD ACH HOOKS UNLESS NOTED OTHERWISE.

ANCHOR BOLTS

1. ANCHOR RODS (ANCHOR BOLTS) SHALL BE PER ASTM F1554 GR 36 (EMBEDMENT PER THE TYPICAL DETAIL).
2. BOLTS, ANCHOR BOLTS, EXPANSION BOLTS, ETC. SHALL BE INSTALLED WITH STEEL WASHERS AND TIGHTENED NUTS.

STRUCTURAL STEEL

1. STRUCTURAL STEEL CONSTRUCTION SHALL CONFORM TO THE LATEST AISC SPECIFICATION FOR THE DESIGN, FABRICATION, AND ERECTION OF STRUCTURAL STEEL FOR BUILDINGS.
2. STRUCTURAL PROPERTIES
CHANNELS, PLATES, AND ANGLES - ASTM A36 (FY = 36 KSI)
BOLTS STEEL/STEEL - ASTM A325N. ALL HIGH-STRENGTH BOLTS SHALL BE TIGHTENED TO THE SNUG-TIGHT CONDITION AS DEFINED BY AISC UNLESS NOTED OTHERWISE.
ANCHOR RODS (ANCHOR BOLTS) - ASTM F1554 GR 36 (EMBEDMENT PER PLAN)
3. BOLTS, ANCHOR BOLTS, EXPANSION BOLTS, ETC. SHALL BE INSTALLED WITH STEEL WASHERS AND TIGHTENED NUTS.
4. WELDING ELECTRODES SHALL CONFORM TO AWS D1.1, GRADE E70XX. ER6 SERIES ELECTRODES SHALL BE USED FOR ASTM A709 REINFORCING BARS. ALL WELDING SHALL BE DONE BY WELDERS HOLDING VALID CERTIFICATES ISSUED BY AN ACCEPTED TESTING AGENCY AND HAVING CURRENT EXPERIENCE IN TYPE OF WELDS SHOWN ON THE DRAWINGS OR NOTES. ALL WELDING PER AMERICAN WELDING SOCIETY STANDARDS. ALL WELDS ON DRAWINGS ARE SHOWN AS SHOP WELDS. CONTRACTOR MAY SHOP WELD OR FIELD WELD AT THEIR DISCRETION. SHOP WELDS OR FIELD WELDS SHALL BE SHOWN ON SHOP DRAWINGS. FULL PENETRATION WELDS SHALL BE TESTED AND CERTIFIED BY AN INDEPENDENT TESTING LABORATORY.
5. IF IT IS NECESSARY TO SPLICE ANY MEMBER, SPLICE LOCATIONS ARE SUBJECT TO REVIEW TO THE ENGINEER OF RECORD. SPLICES SHALL BE FULL PENETRATION WELDED AND TESTED. INDICATE ALL SPLICE LOCATIONS, AND WELDING PROCEDURES ON SHOP DRAWINGS FOR REVIEW PRIOR TO FABRICATION.
6. HEADED STUDS SHALL BE NELSON GRANULAR FILL-GRADED HEADED ANCHOR STUDS OR APPROVED EQUAL MADE FROM COLD FINISHED LOW CARBON STEEL, AND SHALL CONFORM TO ASTM A108, GRADES 1015 OR 1020 WITH A MINIMUM TENSILE STRENGTH OF 60,000 PSI. STUD WELDING INSPECTION AND TESTING SHALL CONFORM TO AWS D1.1.
7. DEFORMED BAR ANCHOR STUDS SHALL BE NELSON GRN. GRANULAR FILL-GRADED REBAR STUDS OR APPROVED EQUAL MADE FROM LOW CARBON COLD ROLLED STEEL WITH A MINIMUM TENSILE STRENGTH OF 70,000 PSI. STUD WELDING INSPECTION AND TESTING SHALL CONFORM TO AWS D1.1.
8. DRYPACK FOR COLUMN BASE PLATES AND BEARING PLATES SHALL BE FIVE STAR GROUT OR AN EQUAL NONMETALLIC SHRINKAGE-RESISTANT GROUT WITH MINIMUM 28 DAY COMPRESSIVE STRENGTH OF 5000 PSI.
9. PROVIDE FABRICATORS STANDARD RUST-INHIBITING PRIMER SHOP PAINT FOR ALL STEEL SURFACES EXCEPT SURFACES EMBEDDED IN CONCRETE, OR TO RECEIVE SPRAY-APPLIED FIREPROOFING.



plandcollab.com 505.268.2266

CONSULTANTS

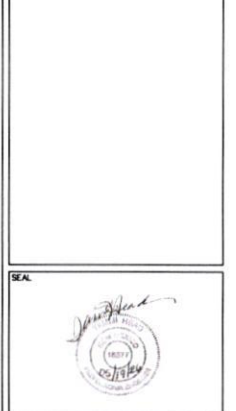

PROJECT NAME AND ADDRESS

RIO COMMUNITIES VETERANS MEMORIAL
360 Rio Communities Blvd.
Rio Communities, NM 87002

DATE: MAY 19, 2026
SUBMITTAL: 100% FOR CONSTRUCTION

REVISIONS	
NO.	DESCRIPTION

PLAND PROJECT NO: 25010
DESIGNED BY TH CHECKED BY TH
DRAWN BY CM

SHEET TITLE

STRUCTURAL NOTES

SHEET NUMBER: S0.1



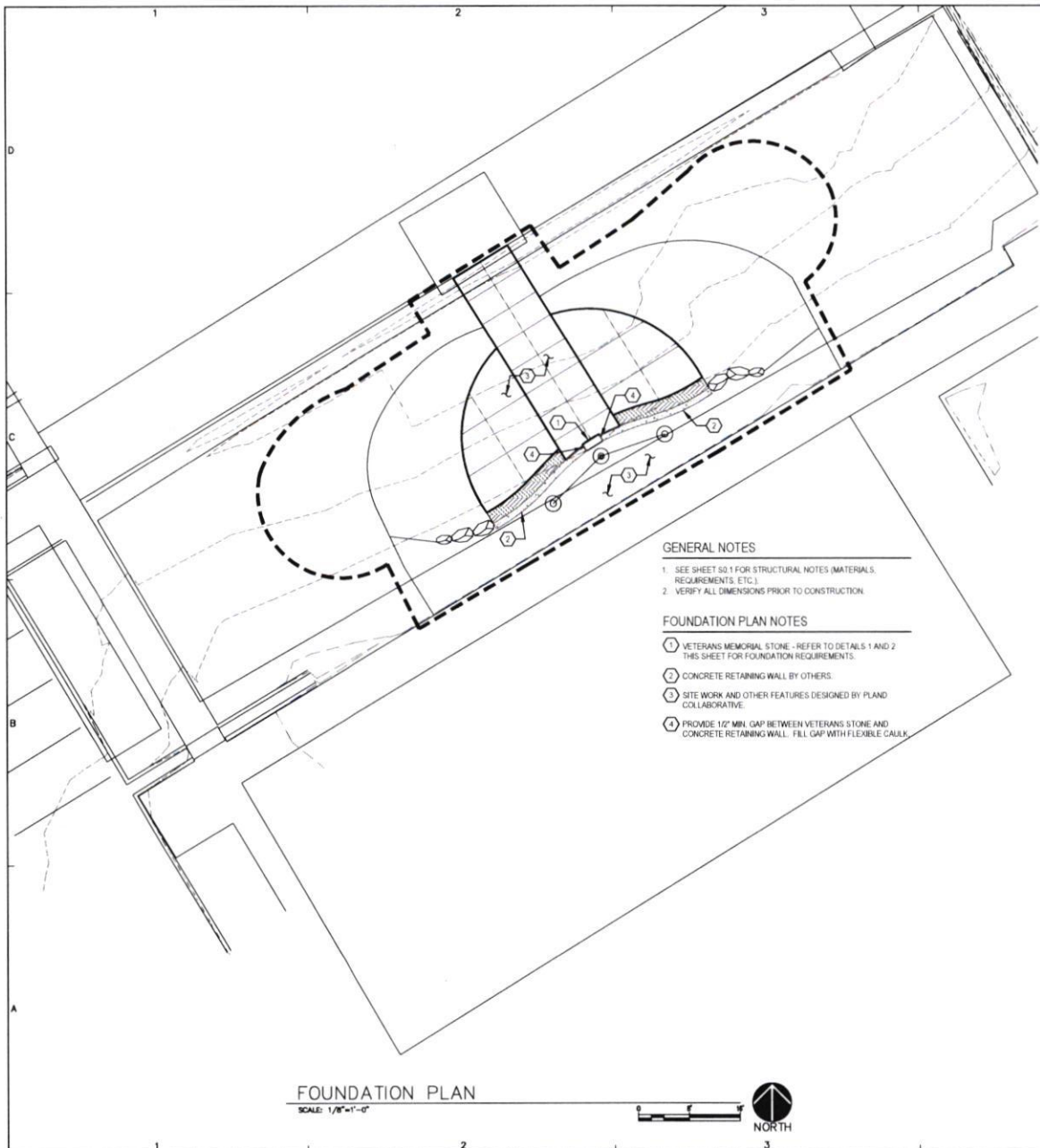

- GENERAL NOTES**
- SEE SHEET S0.1 FOR STRUCTURAL NOTES (MATERIALS, REQUIREMENTS, ETC.)
 - VERIFY ALL DIMENSIONS PRIOR TO CONSTRUCTION.
- FOUNDATION PLAN NOTES**
- VETERANS MEMORIAL STONE - REFER TO DETAILS 1 AND 2 THIS SHEET FOR FOUNDATION REQUIREMENTS.
 - CONCRETE RETAINING WALL BY OTHERS.
 - SITE WORK AND OTHER FEATURES DESIGNED BY PLAND COLLABORATIVE.
 - PROVIDE 1/2" MIN. GAP BETWEEN VETERANS STONE AND CONCRETE RETAINING WALL. FILL GAP WITH FLEXIBLE CAULK.

FOUNDATION PLAN
SCALE: 1/8"=1'-0"

0 1 2 3 4 5
NORTH

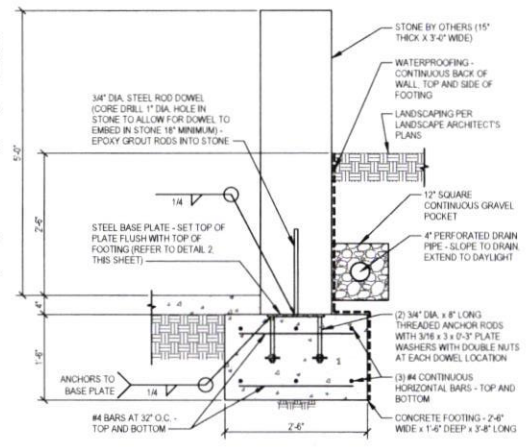

STONE WALL AT CONCRETE FOOTING ①

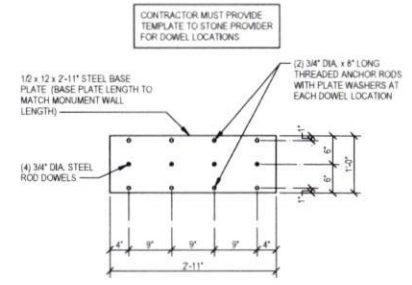

PLAN VIEW OF STEEL BASE PLATE ②



plandcollab.com 505.266.2266

CONSULTANTS

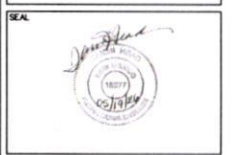

PROJECT NAME AND ADDRESS

RIO COMMUNITIES VETERANS MEMORIAL
360 Rio Communities Blvd.
Rio Communities, NM 87002

DATE SUBMITTED: MAY 10, 2026
100% FOR CONSTRUCTION

REVISIONS

NO.	DATE	DESCRIPTION

PLAND PROJECT NO 26010
DESIGNED BY TH CHECKED BY TH
DRAWN BY CM

SHEET TITLE

FOUNDATION PLAN AND FOUNDATION DETAILS

SHEET NUMBER
S1.1

